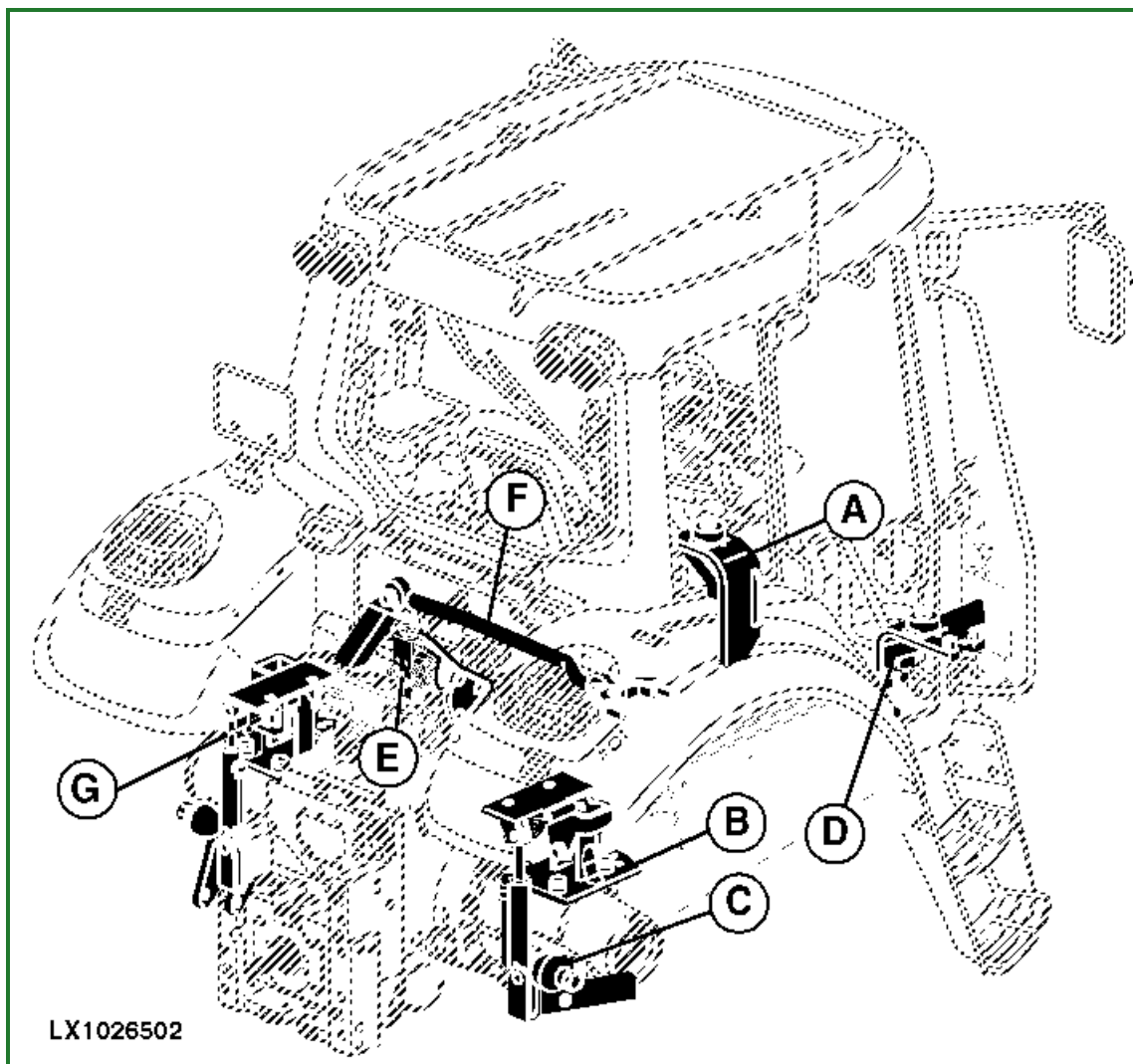

Reference 290-20-050, Hydro-pneumatic Cab Suspension-Components

NOTE:

The description only refers to mechanical and hydraulic components.

**LX1026502-UN: Components****LEGEND:**

- A - Front cab mount (2 used)
- B - Rear cab mount (2 used)
- C - Accumulator (2)
- D - Spherical bearing (2 used)
- E - Control block
- F - Panhard link
- G - Position sensor (2 used)

Rear Mounts (B): They consist essentially of the support and the stop roll which limits horizontal and vertical movement.

Hydraulic Cylinders and Accumulators (C): The hydraulic cylinders move the cab into the position calculated by the control unit (SFA) and registered by the position sensor. Adequate suspension is achieved by the combined action of the hydraulic cylinders and accumulators.

Spherical bearings (D): They are installed in the front cab mounts and consist essentially of a bearing block

which absorbs radial forces and allows rotary movement in all directions.

Control Block (E): The control block is located on the rockshaft support at the rear of the tractor and is operated by two solenoids. It is used to raise or lower the cab depending on requirements. The control block is supplied with pressure oil via “P” and passes on the required amount of oil via “LS”.

Panhard link (F): It is located at the rear of the cab. The panhard link, which limits lateral movement, is connected to the axle housing on one side and to the cab on the other side.

Position sensor (G): The position sensor is located on the left-hand side (as seen in direction of forward travel) of the rear cab mount. It is used to register the “actual” position and to pass this information on to the control unit (SFA).

Go to [Section_290:Group_20](#)

LX25458,0000118-19-01JUN02