

Circle Drive Gearbox Disassemble and Assemble

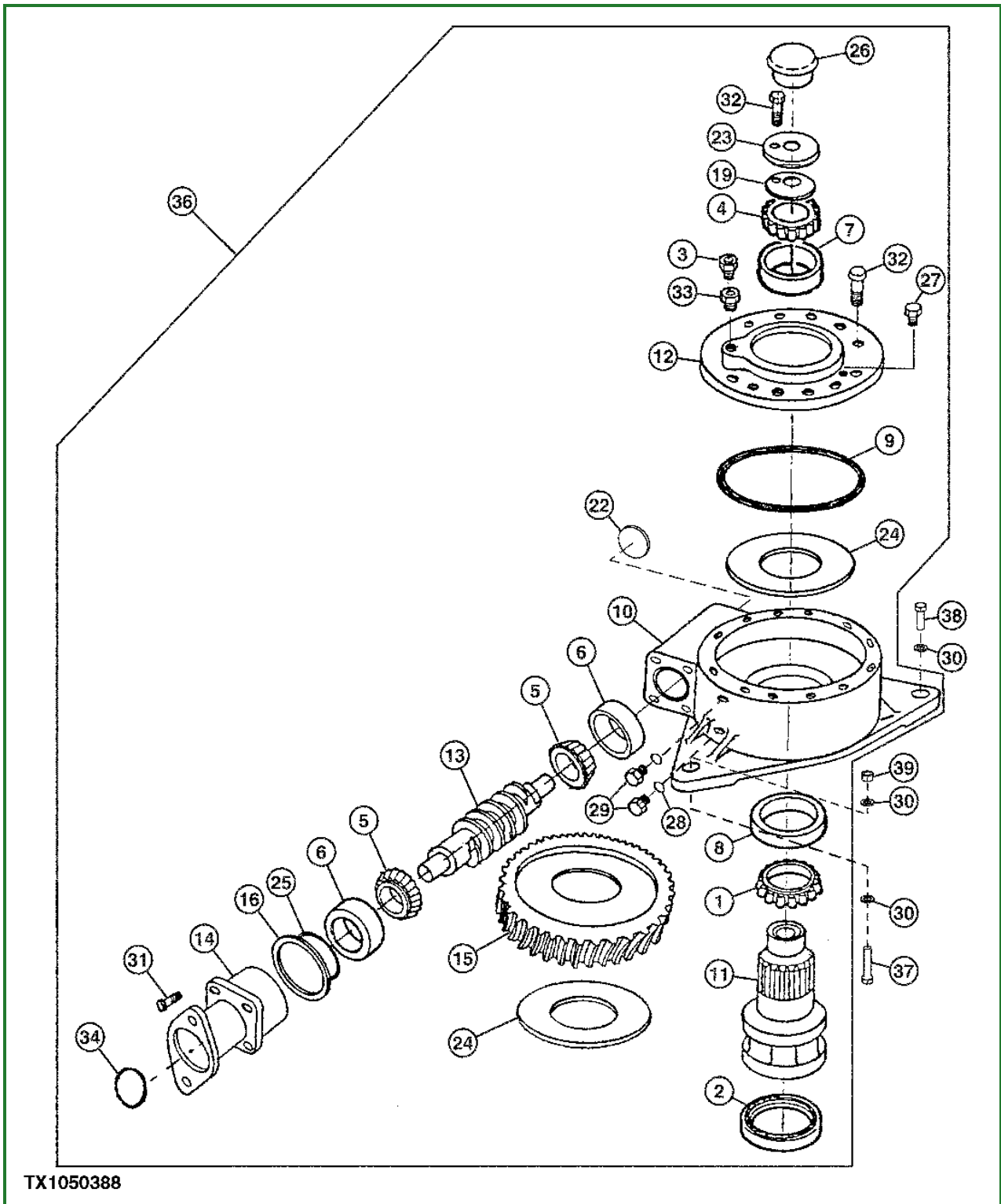

TX1050388-UN: Circle Drive Gearbox

LEGEND:

- 1 - Bearing Cone
- 2 - Seal
- 3 - Pressure Relief Fitting
- 4 - Bearing Cone
- 5 - Bearing Cone (2 used)
- 6 - Bearing Cup (2 used)
- 7 - Bearing Cup
- 8 - Bearing Cup

- 9 - O-Ring
- 10 - Gear Case
- 11 - Pinion Shaft
- 12 - Cover
- 13 - Worm Gear
- 14 - Motor Flange
- 15 - Circle Gear
- 16 - Shim (as required)
- 19 - Shim (as required)
- 22 - Plug
- 23 - Retaining Plate
- 24 - Thrust Washer (2 used)
- 25 - O-Ring
- 26 - Cap
- 27 - Fill Plug
- 28 - O-Ring (2 used)
- 29 - Plug (2 used)
- 30 - Washer (4 used)
- 31 - Cap Screw (4 used)
- 32 - Cap Screw (15 used)
- 33 - Adapter
- 34 - O-Ring
- 36 - Circle Drive Gear Box
- 37 - Cap Screw
- 38 - Cap Screw (2 used)
- 39 - Nut

1. Park machine on flat level surface and lower all attachments to ground.
2. Install articulation lock pin.
3. Turn battery disconnect switch to OFF position.
4. Remove circle drive gearbox from the draft frame. [See Circle Drive Gearbox Remove and Install .](#) (Group 3450.)
5. Remove cap (26).

6.

NOTE:

Note number and position of shims (19) to aid in assembly.

Remove cap screws (32), retaining plate (23) and shims (19) from pinion shaft (11).

7. Remove cap screws (32) from cover (12).

8. **IMPORTANT:**

Prevent possible component damage. Make sure the pinion shaft does not fall out of the bottom of the gearbox when removing the cover and bearing cone.

Install three cap screws in tapped holes in cover (12) and pull bearing cone (4) and bearing cup (7) with