

## Make-Up Check Valve Disassemble and Assemble

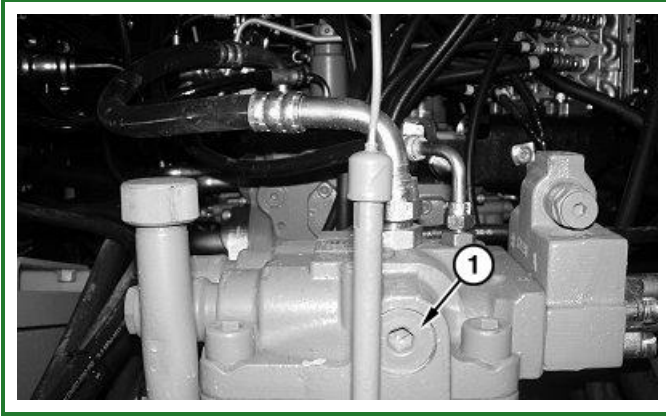

TX1003721A-UN: Make-Up Check Valve

**LEGEND:**

1 - Make-Up Check Valve (2 used)

### *Disassemble and Assemble Make-Up Check Valve—240DLC and 270DLC*

1. Remove make-up check valves (1). See [Crossover Relief Valve and Make-Up Check Valve Remove and Install](#) . (See procedure in this group.)
  
2. Examine O-rings (2), springs (3), and poppets (4) for wear and damage.

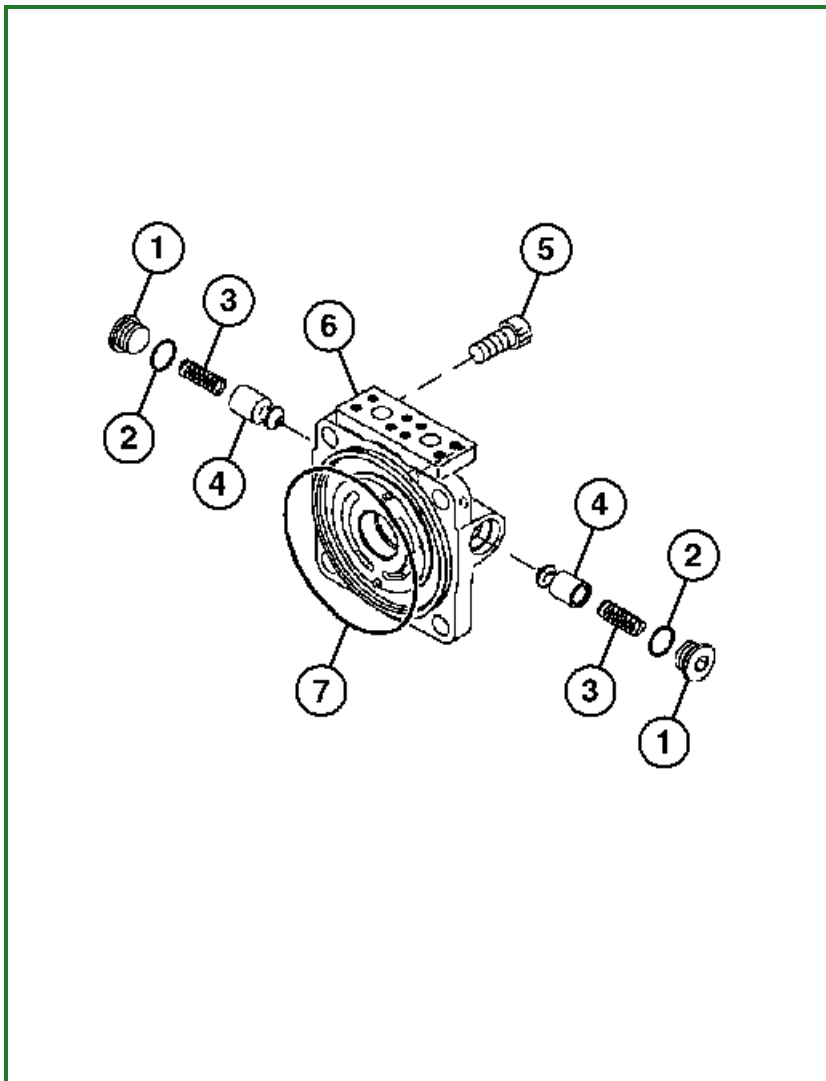

**TX1003722-UN: Make-Up Check Valve**

**LEGEND:**

- 1 - Make-Up Check Valve Plug (2 used)
- 2 - O-Ring (2 used)
- 3 - Spring (2 used)
- 4 - Poppet (2 used)
- 5 - Cap Screw (4 used)
- 6 - Swing Motor Top Plate
- 7 - O-Ring

3. Replace parts as necessary.
4. Install O-rings (2), springs (3), poppets (4), and make-up check valve plugs (1).
5. Tighten make-up check valve plugs (1) to specification. See [Crossover Relief Valve and Make-Up Check Valve Remove and Install](#) . (See procedure in this group.)

Go to [Section\\_43:Group\\_4360](#)

HX00125,000008E-19-20060425