

Hydraulic Fan Pump Flow Test

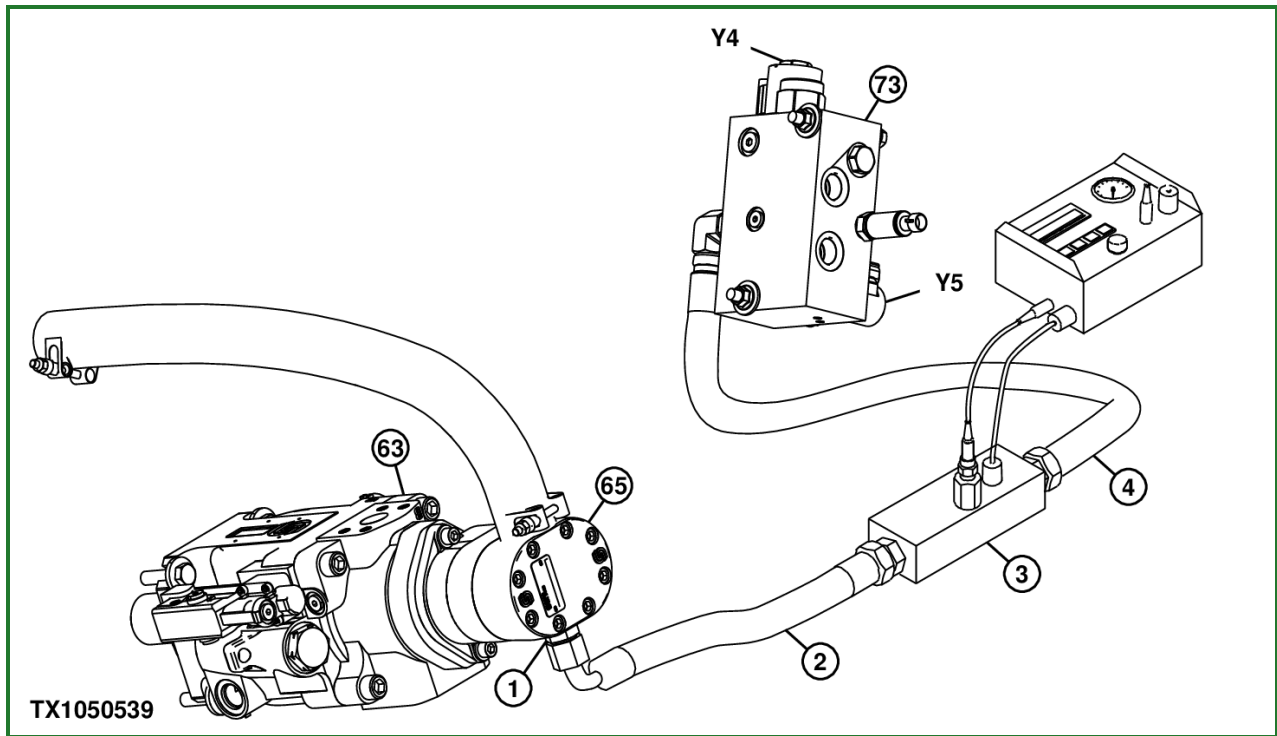

TX1053701-UN: Hydraulic Fan Pump Flow Test

LEGEND:

- 1 - Fan Pump Outlet Port
- 2 - Test Hose (-10 ORFS x -10 ORFS)
- 3 - JT07148 Digital Hydraulic Flowmeter Tester
- 4 - Fan Pump Pressure Hose
- 63 - Main Hydraulic Pump
- 65 - Hydraulic Fan Pump
- 73 - Hydraulic Fan Valve
- Y4 - Hydraulic Fan Speed Solenoid
- Y5 - Hydraulic Fan Direction Solenoid

-: Specifications

SPECIFICATIONS	
Hydraulic Oil Temperature	60—70°C 140—160°F
Engine Speed	Fast Idle
Fan Speed (displayed on PDU)	100%
Hydraulic Fan Pump Flow Rate (new)	68 L/min 18 gpm
Hydraulic Fan Pump Flow Rate (used minimum)	61 L/min 16 gpm

-: Service Equipment and Tools

SERVICE EQUIPMENT AND TOOLS

SERVICE EQUIPMENT AND TOOLS
JT05510 Vacuum Pump (air operated)
Test Hose (-10 ORFS x -10 ORFS)
JT07148 Digital Hydraulic Flowmeter Tester
JT02162 Transducer 34 000 kPa (350 bar) (5000 psi)
JT02156A Digital Pressure/Temperature Analyzer
Gauge 34 000 kPa (350 bar) (5000 psi)

The purpose of this test is to determine hydraulic fan pump flow. Flow not within specification can indicate excessive wear of internal components.

1. Connect vacuum pump to hydraulic oil tank breather hose. [See Vacuum Pump Installation](#) . (Group 9025-25.)
2. Remove fan pump pressure hose (4) from fan pump outlet port (1).
3. Install -10 ORFS x -10 ORFS test hose (2) on fan pump outlet port.
4. Connect opposite end of test hose to inlet port of JT07148 Digital Hydraulic Flowmeter Tester (3).
5. Connect fan pump pressure hose (4) to outlet port of JT07148 Digital Hydraulic Flowmeter Tester (3).
6. Remove vacuum pump from hydraulic oil tank breather hose.
7. Install JT02156A Digital Pressure/Temperature Analyzer and JT02162 Transducer or 34 000 kPa (350 bar) (5000 psi) gauge. [see JT02156A Digital Pressure and Temperature Analyzer Kit Installation](#) . (Group 9025-25.)
8. Warm hydraulic oil to specification. [See Hydraulic Oil Warm-Up Procedure](#) . (Group 9025-25.)

Item	Measurement	Specification
Hydraulic Oil Temperature		60—70°C 140—160°F

9. Set fan speed to 100% on primary display unit (PDU). [See Main Menu—Machine Fan](#) . (Operator's Manual.)
10. Run machine at specification.

Item	Measurement	Specification
Engine	Speed	Fast Idle
Fan (displayed on PDU)	Speed	100%
Hydraulic Oil	Temperature	60—70°C 140—160°F

11. Record fan oil flow reading and compare to specification.