

UNIT REPAIR OVERHAUL REMOVAL

- 1) Disconnect negative (-) cable (1) at battery (2).

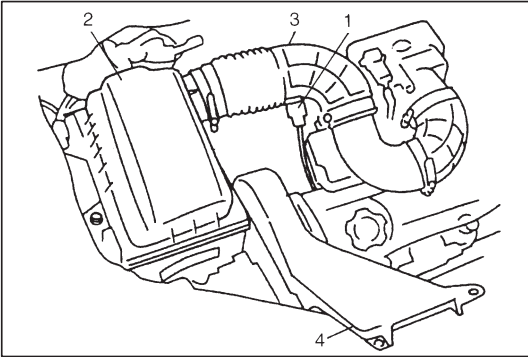

- 2) Disconnect IAT sensor coupler (1).
- 3) Remove air cleaner assembly (2) with air cleaner outlet No.1 hose (3) and suction pipe (4).
- 4) Remove generator cover.

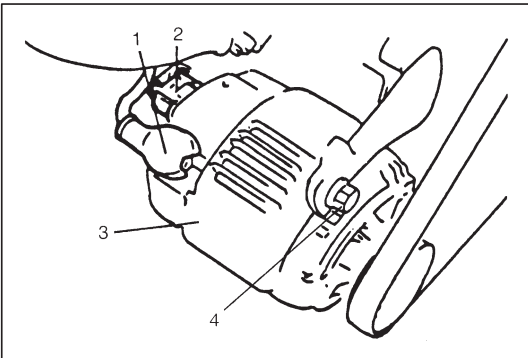

- 5) Disconnect "B" terminal wire (1) and coupler (2) from generator (3).
- 6) Remove upper generator bolt (4).
- 7) Hoist vehicle.

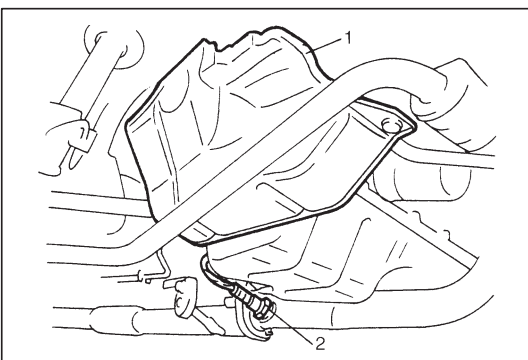

- 8) Remove left side of engine under cover (1) and oxygen sensor No.2 (2).

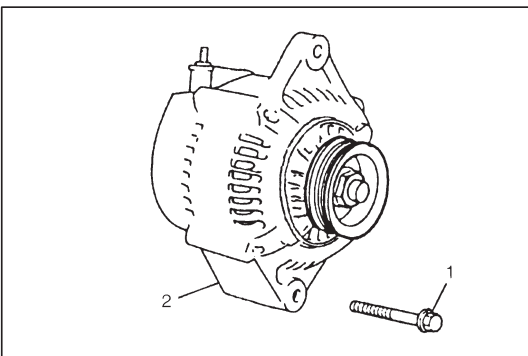

- 9) Remove generator belt referring to SECTION 6B.
- 10) Remove lower generator bolt (1), and then remove generator (2).

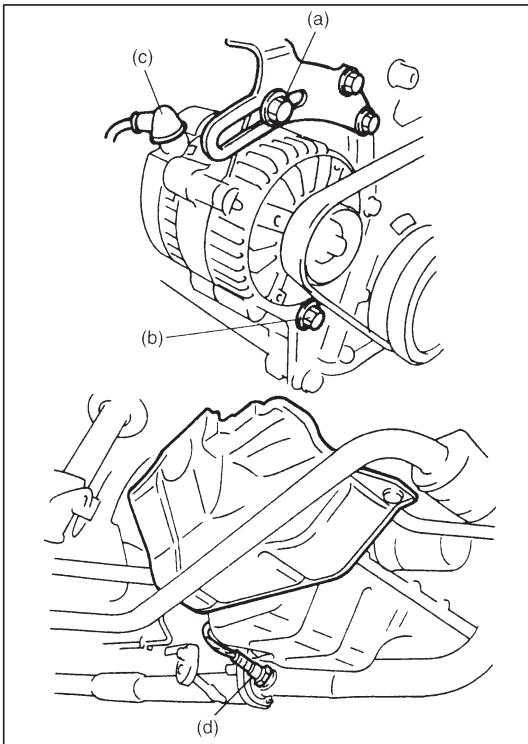

INSTALLATION

Reverse removal procedure and giving specified tension to water pump and generator drive belt referring to SECTION 6B.

Tightening Torque

(a): 22 N·m (2.2 kg-m, 16.0 lb-ft)

(b): 50 N·m (5.0 kg-m, 36.5 lb-ft)

(c): 7.8 N·m (0.78 kg-m, 5.5 lb-ft)

(d): 45 N·m (4.5 kg-m, 32.5 lb-ft)

DISASSEMBLY

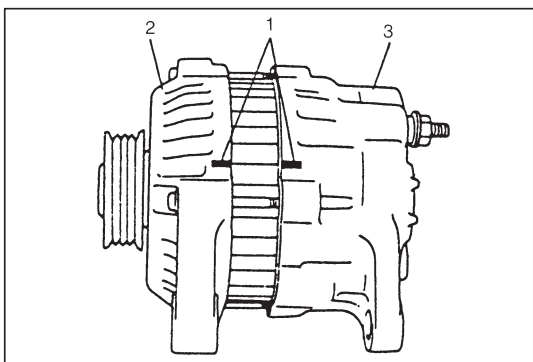
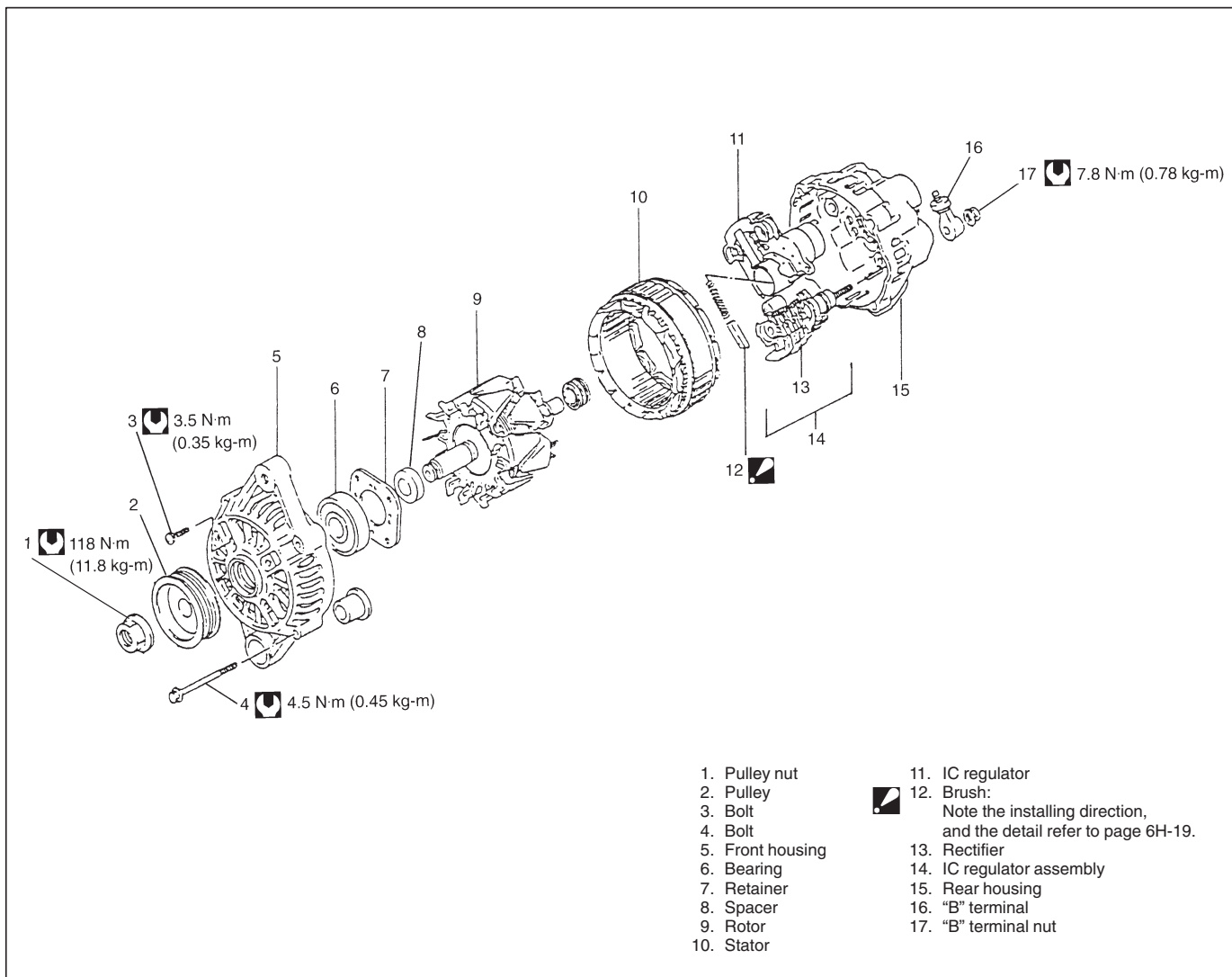

1) For easier reinstallation, provide match marks (1) on front housing (2) and rear housing (3) as shown before separating them.

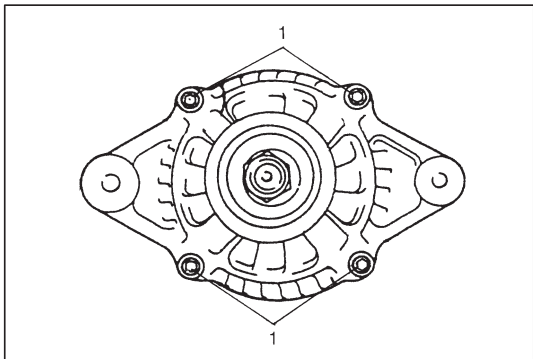

2) Remove housing bolts (1) from generator.