

Frame Replacement

Special tool
J 39580 Engine Support Table

Removal Procedure

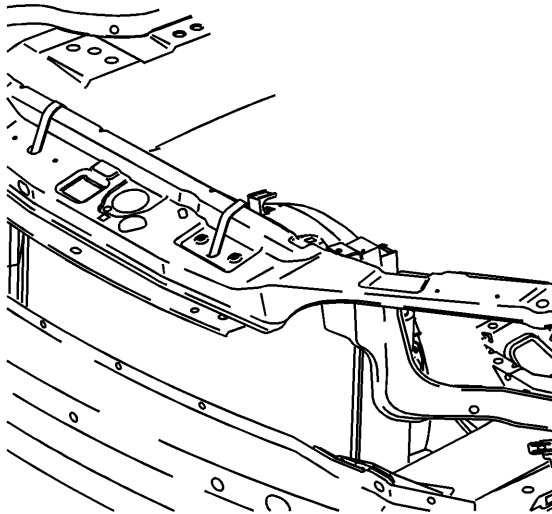

1. Tie the radiator, air conditioning condenser, and fan module assembly to the upper radiator support to keep the assembly with the vehicle when the frame is lowered.
2. Install the engine support fixture. Refer to "Engine Support Fixture: ".
3. Raise and support the vehicle. Refer to "Lifting and Jacking the Vehicle: ".
4. Remove the front wheels. Refer to "Tire and Wheel Removal and Installation: ".
5. Remove the side splash shield-to-frame fasteners.
6. Remove the front air dam-to-frame fasteners.

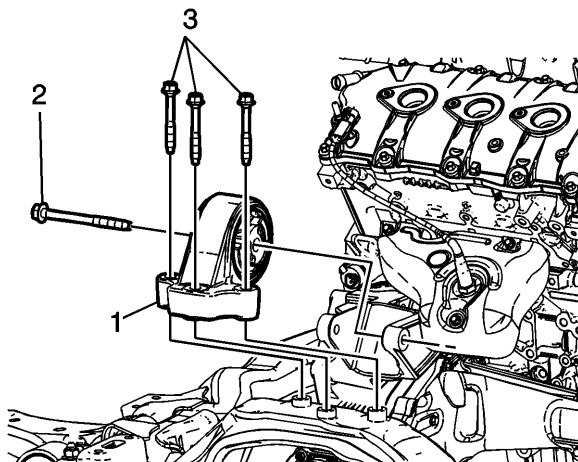

7. Remove the rear transmission mount-to-frame bolts (3).

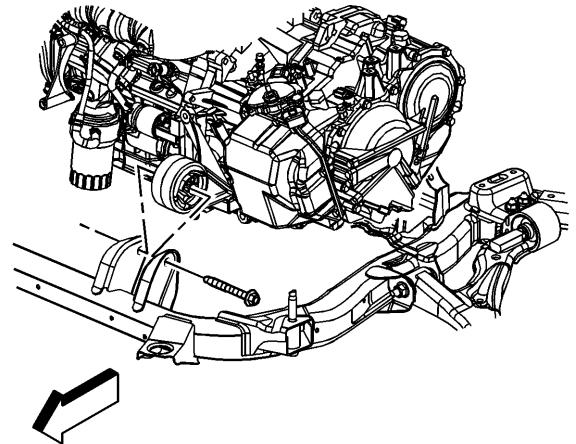

8. Remove the front transmission mount-to-frame bolt.

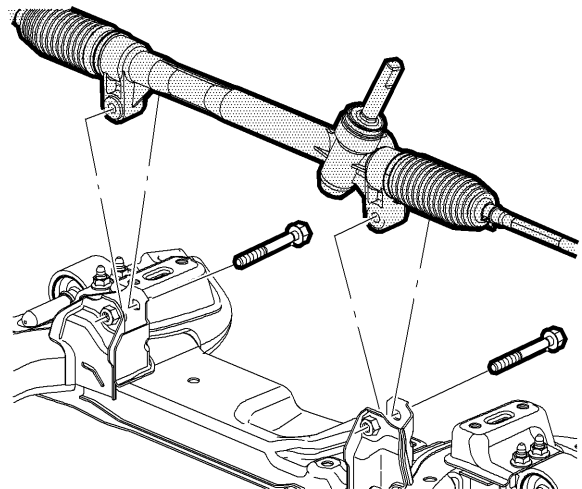

9. Remove the steering gear-to-frame bolts.
10. Using mechanics wire, secure the steering gear to the exhaust.

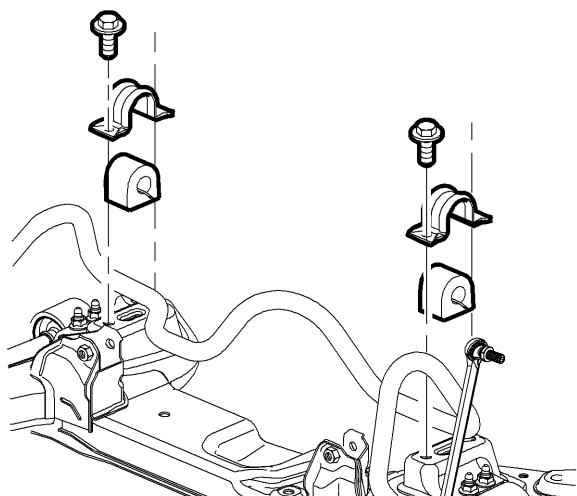

11. Remove the stabilizer shaft clamp-to-frame bolts.

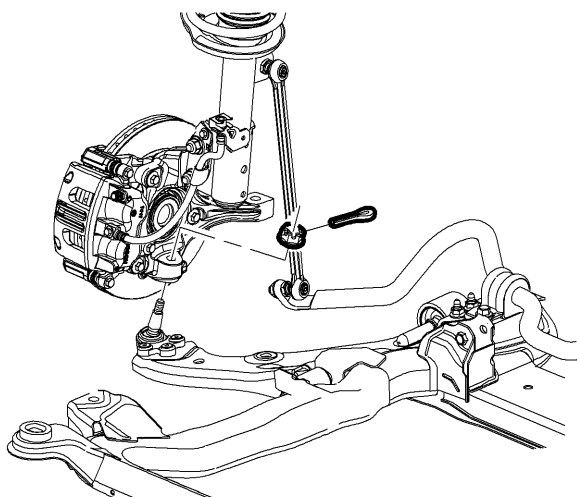

12. Separate the lower ball joint from the steering knuckle. Refer to "Lower Control Arm Replacement: "

13. Remove the power steering cooler line retainer clips from the frame.

14. Lower the vehicle until the frame contacts J 39580.

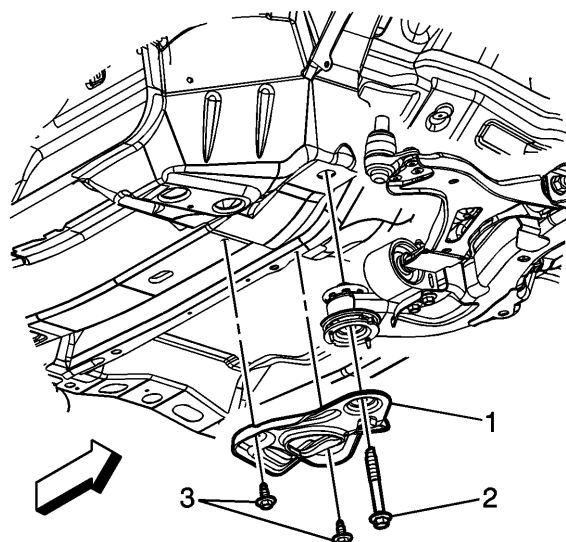

15. Remove the reinforcement bolts (3).

16. Remove the rear frame to body bolts (2). DISCARD the bolts.

17. Remove the reinforcement (1) from the vehicle.

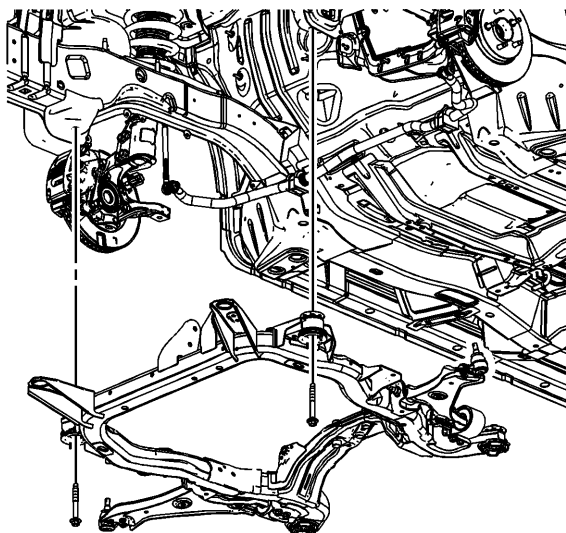

18. Remove the front frame-to-body bolts. DISCARD the bolts.

19. Carefully raise the vehicle in order to separate the frame from the body.

20. Remove the lower control arms. Refer to "Lower Control Arm Replacement: "