

# POWER STEERING GEAR AND LINKAGE

SEC. 492

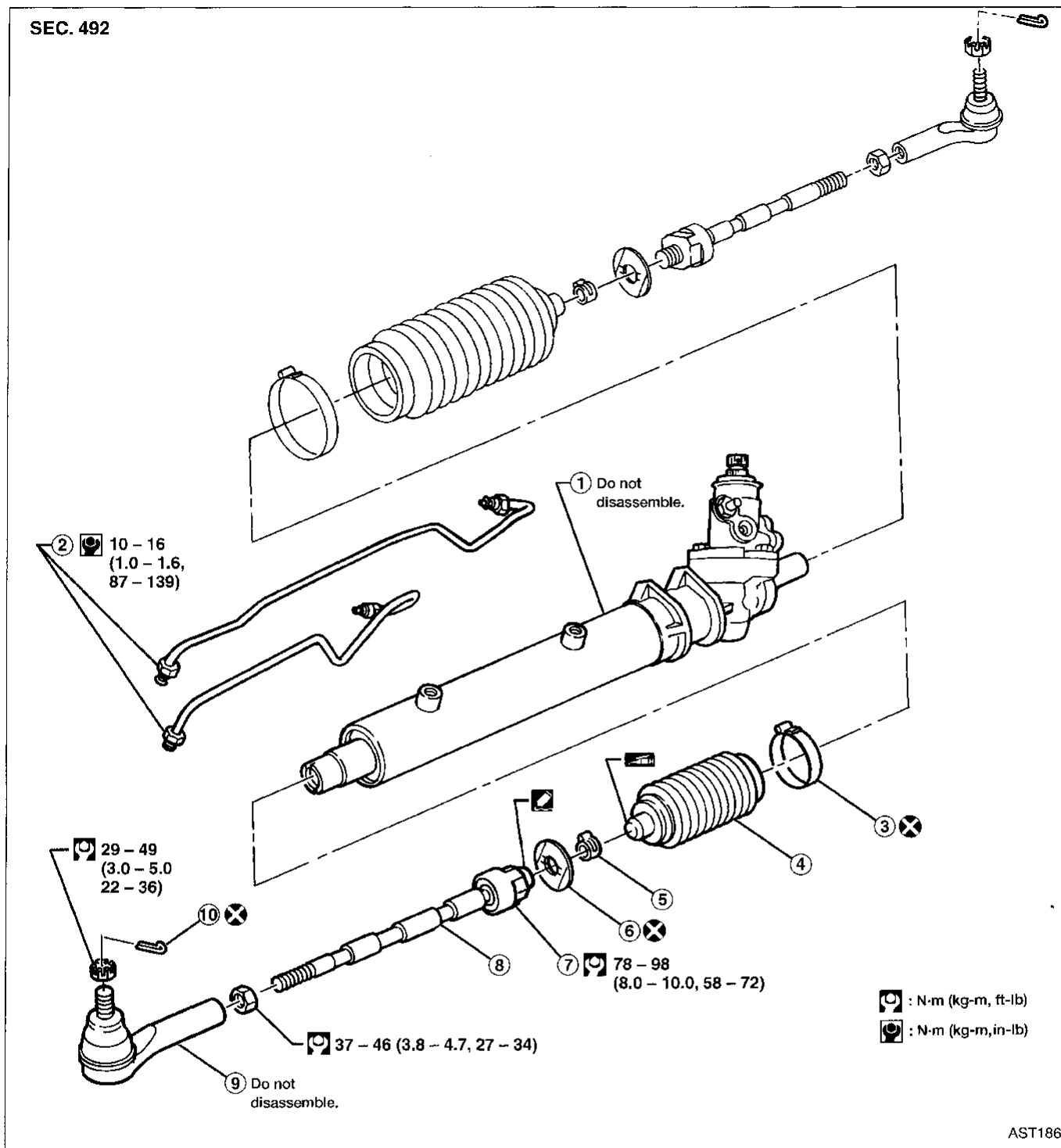

AST186

- |                     |                        |                        |
|---------------------|------------------------|------------------------|
| ① Steering gear     | ⑤ Boot band            | ⑧ Tie-rod              |
| ② Gear housing tube | ⑥ Lock plate           | ⑨ Tie-rod outer socket |
| ③ Boot clamp        | ⑦ Tie-rod inner socket | ⑩ Cotter pin           |
| ④ Dust boot         |                        |                        |

# NISSAN ALTIMA

**MODEL U13 SERIES  
FROM SERIAL  
NO. 148475~**

## FOREWORD

This supplement contains information concerning necessary service procedures and relevant data for the 1997 model U13 series produced from SERIAL NO. 148475~.

All information, illustrations and specifications contained in this supplement are based on the latest product information available at the time of publication. If your NISSAN model differs from the specifications contained in this supplement, consult your NISSAN distributor for information.

## QUICK REFERENCE INDEX

<b>GENERAL INFORMATION</b> _____	<b>GI</b>
<b>MAINTENANCE</b> _____	<b>MA</b>
<b>ENGINE MECHANICAL</b> _____	<b>EM</b>
<b>ENGINE LUBRICATION &amp; COOLING SYSTEMS</b> _____	<b>LC</b>
<b>ENGINE CONTROL SYSTEM</b> _____	<b>EC</b>
<b>ACCELERATOR CONTROL, FUEL &amp; EXHAUST SYSTEMS</b> _____	<b>FE</b>
<b>CLUTCH</b> _____	<b>CL</b>
<b>MANUAL TRANSAXLE</b> _____	<b>MT</b>
<b>AUTOMATIC TRANSAXLE</b> _____	<b>AT</b>
<b>FRONT AXLE &amp; FRONT SUSPENSION</b> _____	<b>FA</b>
<b>REAR AXLE &amp; REAR SUSPENSION</b> _____	<b>RA</b>
<b>BRAKE SYSTEM</b> _____	<b>BR</b>
<b>STEERING SYSTEM</b> _____	<b>ST</b>
<b>RESTRAINT SYSTEM</b> _____	<b>RS</b>
<b>BODY &amp; TRIM</b> _____	<b>BT</b>
<b>HEATER &amp; AIR CONDITIONER</b> _____	<b>HA</b>
<b>ELECTRICAL SYSTEM</b> _____	<b>EL</b>
<b>ALPHABETICAL INDEX</b> _____	<b>IDX</b>