

# 2013 Lexus GS 450h

## 2013 TRANSMISSION Hybrid Transaxle (Service Information) - GS450h

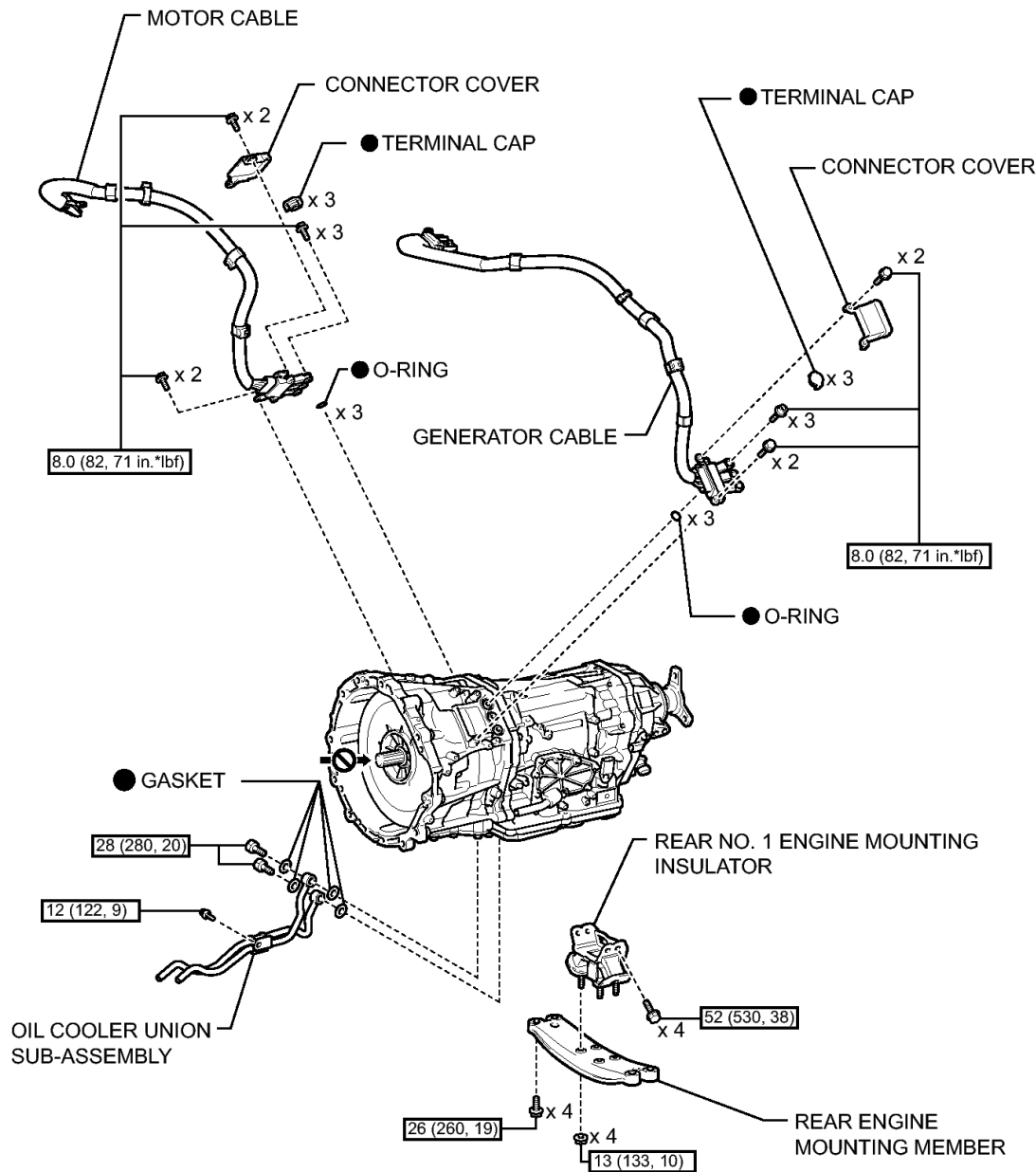

[N\*m (kgf\*cm, ft.\*lbf)]: Specified torque

● Non-reusable part

⚡ Do not apply lubricants (to the threaded parts)

P

**Fig. 2: Identifying Hybrid Vehicle Transmission Replacement Components With Torque Specifications (2 Of 3)**

Courtesy of TOYOTA MOTOR SALES, U.S.A., INC.

## ILLUSTRATION

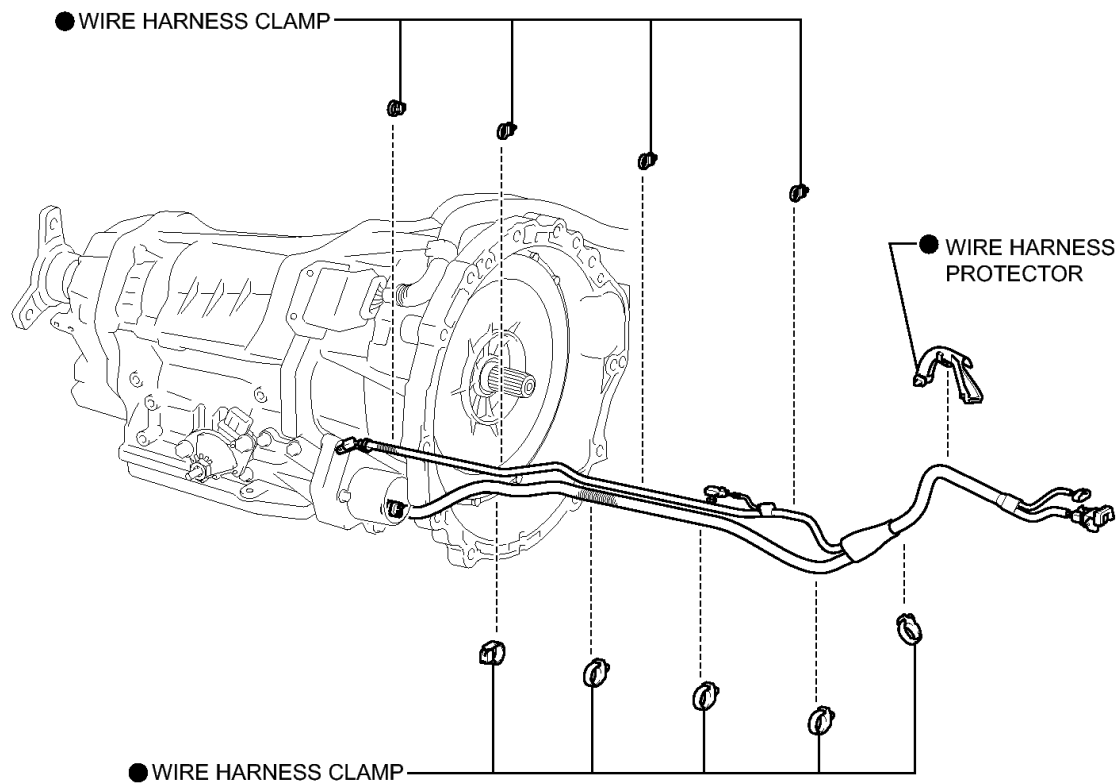

● Non-reusable part

T

**Fig. 3: Identifying Hybrid Vehicle Transmission Replacement Components (3 Of 3)**  
 Courtesy of TOYOTA MOTOR SALES, U.S.A., INC.

### REMOVAL [03/2012 - ]

#### REMOVAL [03/2012 - ]

##### 1. PRECAUTION

Refer to **PRECAUTION [03/2012 - ]**

##### 2. REMOVE ENGINE WITH TRANSMISSION

Refer to **REMOVAL [03/2012 - ]**.

##### 3. DISCONNECT CONNECTOR

- a. Disconnect the shift lever position sensor connector, transmission wire connector, oil pressure sensor connector, transmission speed sensor connector, O/P THERM connector, engine oil level sensor connector, motor revolution sensor connector and generator revolution sensor connector.