

15. Remove mounting bolts (37) and (38) and alternator.

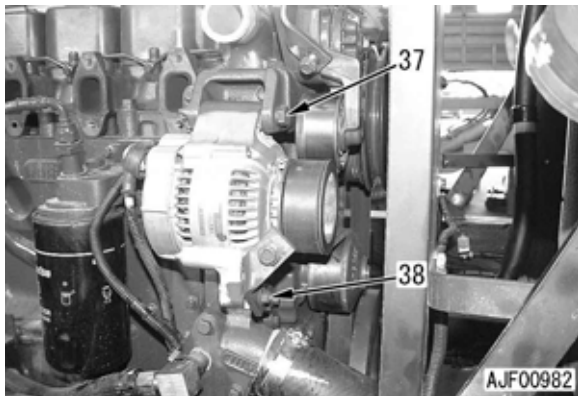

19. Remove engine stop solenoid bracket mounting bolts and nuts (43). [*9]

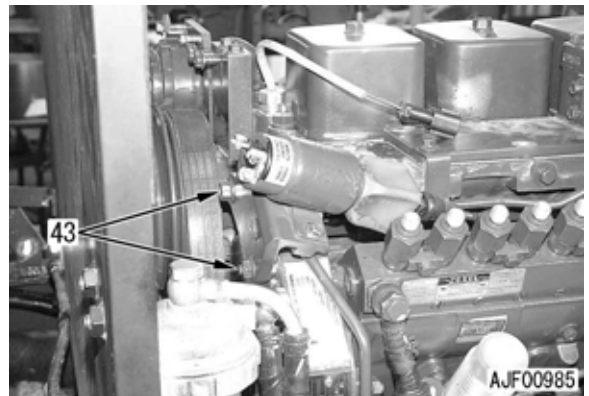

16. Remove alternator bracket (40).

17. Remove engine sling and thermostat housing assembly (41). [*8]

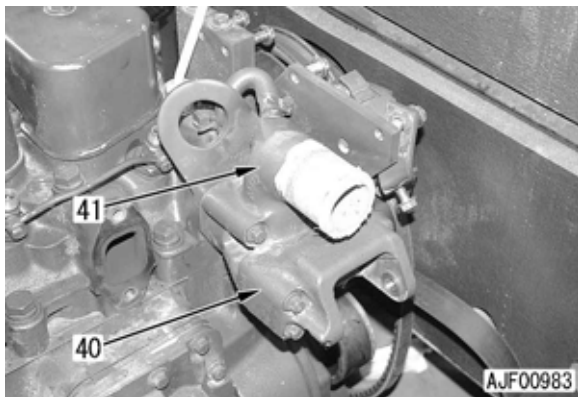

20. Disconnect air hose (44). [*10]

21. Remove air intake connector (45) and heater (46).

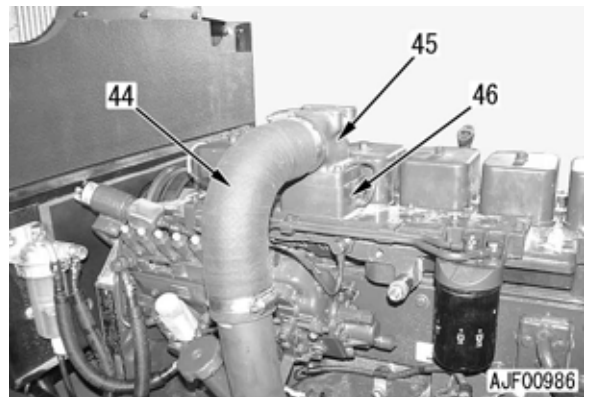

18. Remove air conditioner compressor bracket (42).

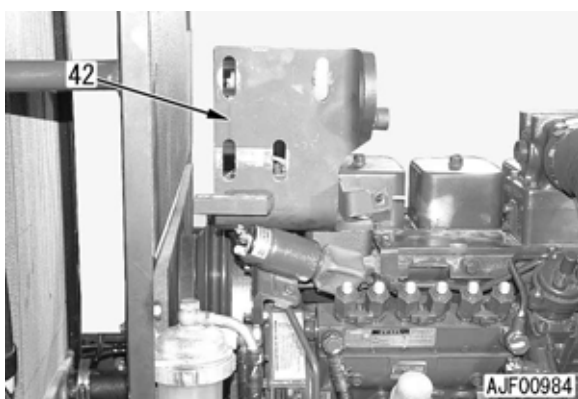

22. Remove boost compensator tube (47).

23. Remove fuel tubes (48) and (49).

24. Remove fuel filter (50).

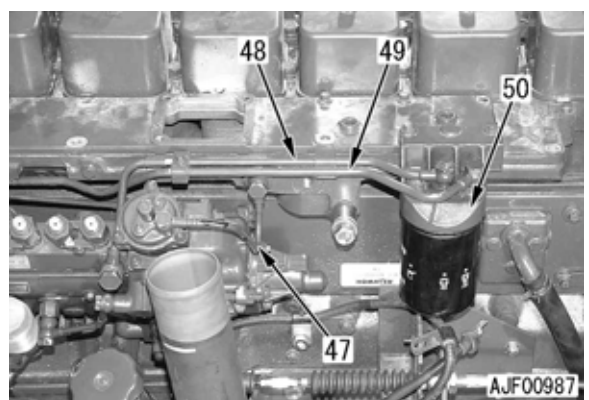

- 25. Disconnect spill hose (51).
- 26. Disconnect heater hose (52).

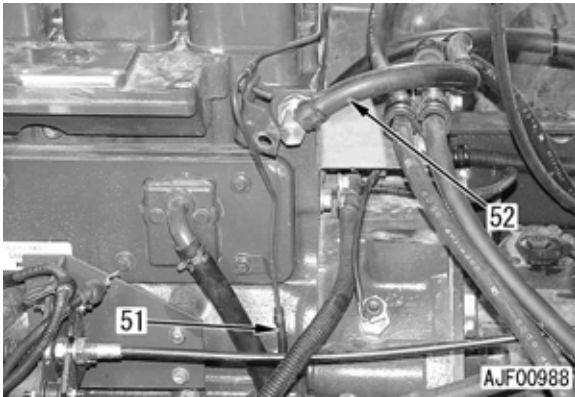

★ If the nozzle holder is difficult to remove, use tool **A3**.

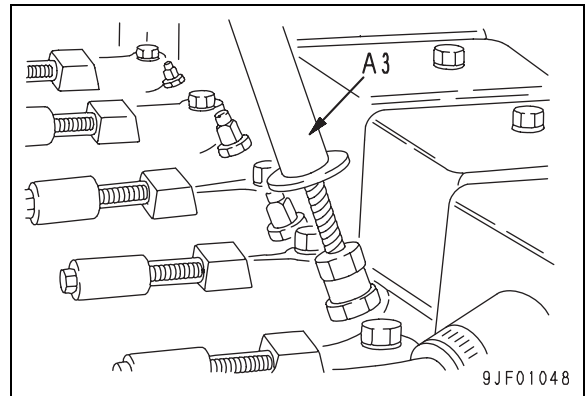

- 27. Remove spill tube (53).

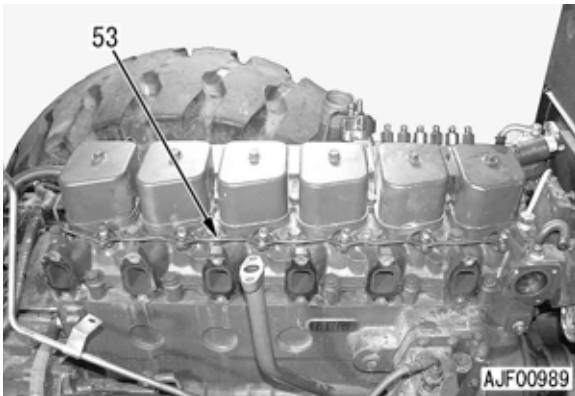

- 29. Remove 6 cylinder head covers (55). [*12]

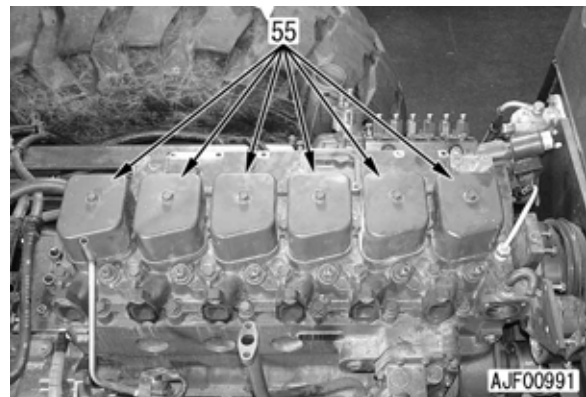

- 28. Remove 6 nozzle holders (54). [*11]

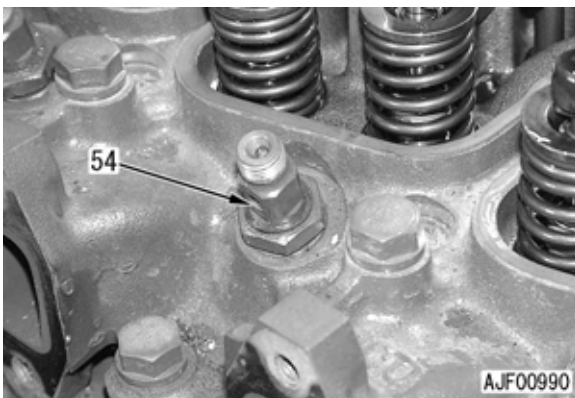

- 30. Remove rocker arm (56). [*13]
- ★ Loosen the locknut, and then loosen adjustment screw by 2 - 3 turns.

