

Symbol	Description
	N·m (kg-m, ft-lb)
	N·m (kg-m, in-lb)
	Always replace after disassembly.

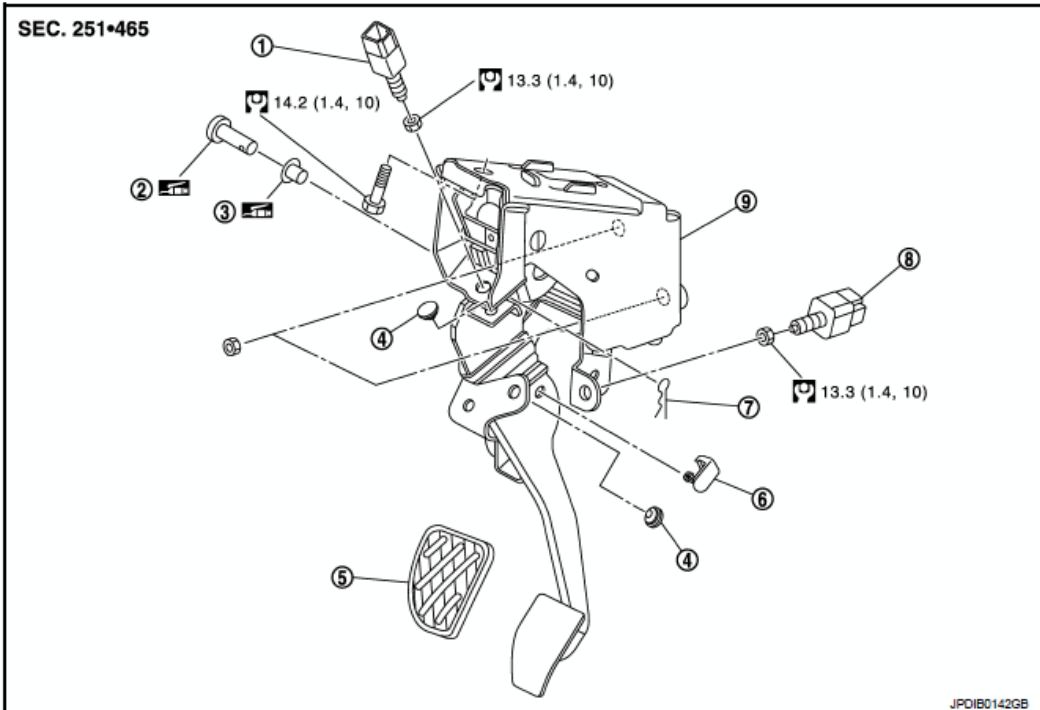

- |                       |                            |                         |
|-----------------------|----------------------------|-------------------------|
| 1. ASCD clutch switch | 2. Clevis pin              | 3. Bushing              |
| 4. Stopper rubber     | 5. Pedal pad               | 6. Pedal stopper rubber |
| 7. Snap pin           | 8. Clutch interlock switch | 9. Clutch pedal         |

: Apply lithium-based grease including molybdenum disulphide.

**Fig. 9: Exploded View Of Clutch Pedal With Torque Specifications**  
 Courtesy of NISSAN NORTH AMERICA, INC.

### Removal and Installation

#### REMOVAL

1. Remove front kicking plate inner and dash side finisher. Refer to **REMOVAL AND INSTALLATION**.
2. Remove instrument lower panel LH. Refer to **M/T MODELS: REMOVAL AND INSTALLATION**.
3. Remove bracket (1) and harness bracket (2).
4. Disconnect ASCD clutch switch and clutch interlock switch connectors and then remove clip of harness from clutch pedal.
5. Remove snap pin and clevis pin from clevis.
6. Remove ASCD clutch switch, clutch interlock switch, and pedal pad from clutch pedal.

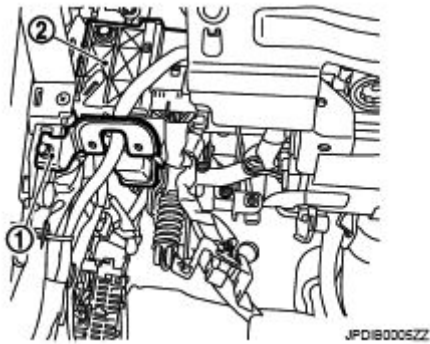

**Fig. 10: Identifying Clutch Pedal Bracket And Harness Bracket**  
Courtesy of NISSAN NORTH AMERICA, INC.

7. Remove stopper rubbers and pedal stopper rubber from clutch pedal, using a suitable remover.
8. Remove clutch pedal from the vehicle.
9. Remove bushing from clutch pedal, using a suitable drift [Commercial service tool].

#### INSTALLATION

Note the following, and install in the reverse order of removal.

- Apply recommended grease to bushing.
- Apply recommended grease to clevis pin.

#### Inspection and Adjustment

#### INSPECTION AFTER REMOVAL

Check the following items and replace clutch pedal if necessary.

- Check clutch pedal upper rivets (A) for deformation.

← : Vehicle front

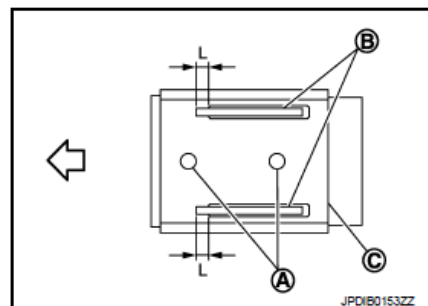

**Fig. 11: Identifying Sub-Bracket And Slide Plate Lapping Length L**  
Courtesy of NISSAN NORTH AMERICA, INC.

- Check the lapping length "L" of sub-bracket (B) and slide plate (C).

**Lapping length "L": More than 5 mm (0.20 in)**

- Check clutch pedal for bend, damage, and cracks on the welded parts.