

SUPPLEMENTAL RESTRAINT SYSTEM (SRS)

SRS Component Parts Location

SRS Component Parts Location

NCRS0011

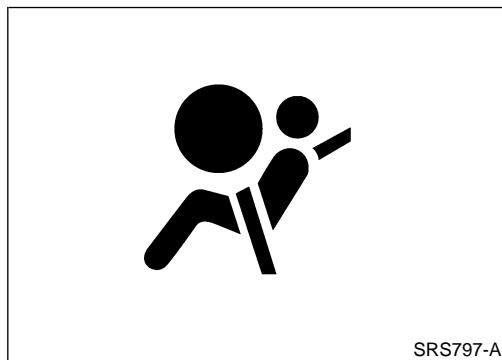
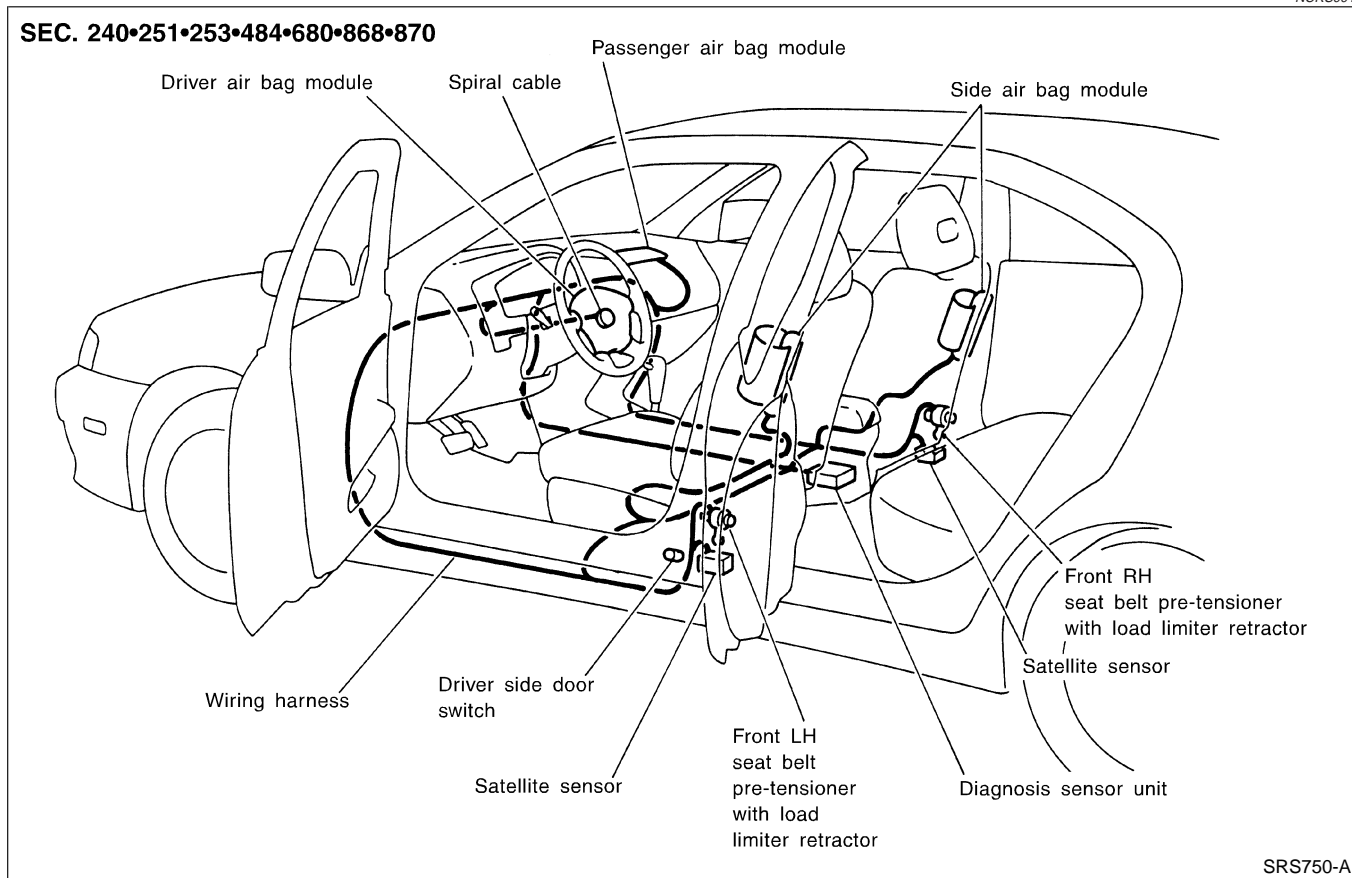

Maintenance Items

NCRS0012

CAUTION:

Do not use a circuit tester to check SRS circuit.

1. Check operation of "AIR BAG" warning lamp.
After turning ignition key to "ON" position, "AIR BAG" warning lamp illuminates. The "AIR BAG" warning lamp will go off after about 7 seconds if no malfunction is detected. If any of the following warning lamp conditions occur, immediately check the air bag system. Refer to RS-39 for details.
 - The "AIR BAG" warning lamp does not illuminate when the ignition switch is turned "ON".
 - The "AIR BAG" warning lamp does not go off about 7 seconds after the ignition switch is turned "ON".
 - The "AIR BAG" warning lamp blinks after about 7 seconds after the ignition switch is turned "ON".
2. Visually check SRS components.
 - 1) Diagnosis sensor unit
 - Check diagnosis sensor unit and bracket for dents, cracks and deformities.
 - Check connectors for damage, and terminals for deformities.
 - 2) Air bag module and steering wheel
 - Remove air bag module from steering wheel, instrument panel

SUPPLEMENTAL RESTRAINT SYSTEM (SRS)

Maintenance Items (Cont'd)

- or seatback. Check harness cover and connectors for damage, terminals for deformities, and harness for binding.
- Install driver air bag module to steering wheel to check fit or alignment with the wheel. GI
- Check steering wheel for excessive free play. MA
- Install passenger air bag module to instrument panel to check fit or alignment with the instrument panel. EM
- Install side air bag module to seatback to check fit and alignment with the seat.
- 3) Spiral cable LC
- Check spiral cable for dents, cracks, or deformities.
- Check connectors and protective tape for damage.
- Check steering wheel for noise, binding or heavy operation. EC
- 4) Main harness, air bag harness, body harness, side air bag module sub-harness FE
- Check connectors for poor connections, damage, and terminals for deformities.
- Check harnesses for binding, chafing or cut. CL
- 5) Seat belt pre-tensioner MT
- Check harness cover and connectors for damage, terminals for deformities, and harness for binding.
- Check belts for damage and anchors for loose mounting.
- Check retractor for smooth operation.
- Perform self-diagnosis for seat belt pre-tensioner using air bag warning lamp or CONSULT-II. Refer to “SRS Operation Check” for details. (RS-39) AT
- 6) Satellite sensor AX
- Check satellite sensor (including bracket portion) for dents, cracks or deformities. SU
- Check connectors for damage, and terminals for deformities.

CAUTION:

Replace previously used special bolts, hex bolts and ground bolt with new ones. BR

Diagnosis Sensor Unit

REMOVAL AND INSTALLATION

NCRS0013

CAUTION:

- Before servicing SRS, turn the ignition switch off, disconnect both battery cables and wait for at least 3 minutes. RS
- The special bolts are coated with bonding agent while the other bolt is for ground. Do not use old bolts after removal; replace with new ones. BT
- Check diagnosis sensor unit for proper installation. HA
- Check diagnosis sensor unit to ensure it is free of deformities, dents, cracks or rust. If they show any visible signs of damage, replace them with new ones. SC
- Check diagnosis sensor unit brackets to ensure they are free of deformities or rust.
- Replace diagnosis sensor unit if it has been dropped or sustained an impact. EL
- After replacement of diagnosis sensor unit, perform self-diagnosis for SRS. Refer to “SRS Operation Check” for details (RS-39). IDX