

A/T CONTROL SYSTEM

< SYSTEM DESCRIPTION >

[7AT: RE7R01A (VQ37VHR)]

Component Parts Location

INFOID:0000000110578840

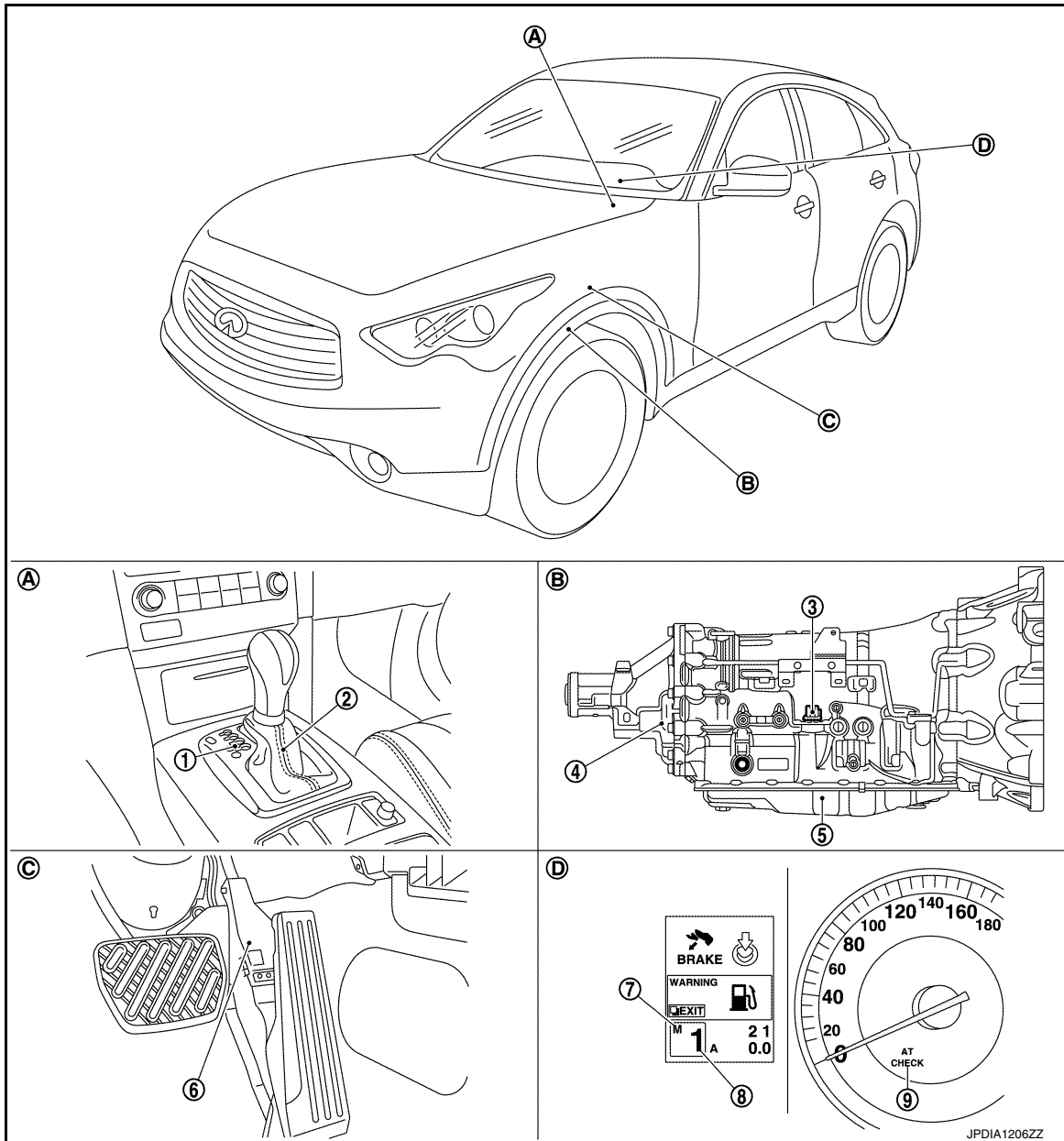

- | | | |
|--------------------------------------|--------------------------------|--------------------------------------|
| 1. Selector lever position indicator | 2. A/T shift selector assembly | 3. Joint connector |
| 4. Control valve & TCM* | 5. Output speed sensor | 6. Accelerator pedal position sensor |
| 7. Manual mode indicator | 8. Shift position indicator | A/T CHECK indicator lamp |
| A. Center console | B. A/T assembly | C. Accelerator pedal |
| D. Combination meter | | |

NOTE:

- The following components are included in A/T shift selector assembly.
 - Manual mode select switch
 - Manual mode position select switch
 - Shift position switch
- The following components are included in control valve & TCM.
 - TCM
 - Input speed sensor 1, 2
 - A/T fluid temperature sensor

A
B
C
TM
E
F
G
H
I
J
K
L
M
N
O
P

A/T CONTROL SYSTEM

[7AT: RE7R01A (VQ37VHR)]

< SYSTEM DESCRIPTION >

- Transmission range switch
- Direct clutch solenoid valve
- High and low reverse clutch solenoid valve
- Input clutch solenoid valve
- Front brake solenoid valve
- Low brake solenoid valve
- Anti-interlock solenoid valve
- 2346 brake solenoid valve
- Line pressure solenoid valve
- Torque converter clutch solenoid valve

*: Control valve & TCM is included in A/T assembly.

Component Description

INFOID:000000010578841

Name	Function
TCM	The TCM consists of a microcomputer and connectors for signal input and output and for power supply. The TCM controls the A/T.
Transmission range switch	TM-75, "Description"
Output speed sensor	TM-81, "Description"
Input speed sensor 1	TM-79, "Description"
Input speed sensor 2	
A/T fluid temperature sensor	TM-76, "Description"
Input clutch solenoid valve	TM-105, "Description"
Front brake solenoid valve	TM-108, "Description"
Direct clutch solenoid valve	TM-123, "Description"
High and low reverse clutch solenoid valve	TM-120, "Description"
Low brake solenoid valve	TM-121, "Description"
Anti-interlock solenoid valve	TM-104, "Description"
2346 brake solenoid valve	TM-122, "Description"
Line pressure solenoid valve	TM-103, "Description"
Torque converter clutch solenoid valve	TM-99, "Description"
Accelerator pedal position sensor	TM-109, "Description"
Manual mode switch	TM-117, "Description"
Starter relay	TM-73, "Description"
A/T CHECK indicator lamp	When the ignition switch is pushed to the ON position, the light comes on for 2 seconds.
Stop lamp switch	TM-129, "Description"
ECM	EC-51, "System Description"
BCM	BCS-9, "System Description"
Unified meter and A/C amp.	MWI-6, "METER SYSTEM : System Description"
ABS actuator and electric unit (control unit)	BRC-22, "System Description"
Yaw rate/side G sensor	BRC-73, "Description"