



EAS00576

FRONT BRAKE

- ① Retaining bolt
- ② Air bleed screw
- ③ Caliper assembly
- ④ Pad spring
- ⑤ Pad set
- ⑥ Retaining pin
- ⑦ Brake pad cover
- ⑧ Brake disc
- ⑨ Master cylinder cap
- ⑩ Diaphragm
- ⑪ Brake hose
- ⑫ Brake pump assy
- ⑬ Front brake lever
- ⑭ Copper washers
- ⑮ Union bolt
- ⑯ Brake light switch cable

Type of brake fluid: DOT #4
Wear limit of brake pads: 0.5 mm
Wear limit of brake disc: 3.0 mm

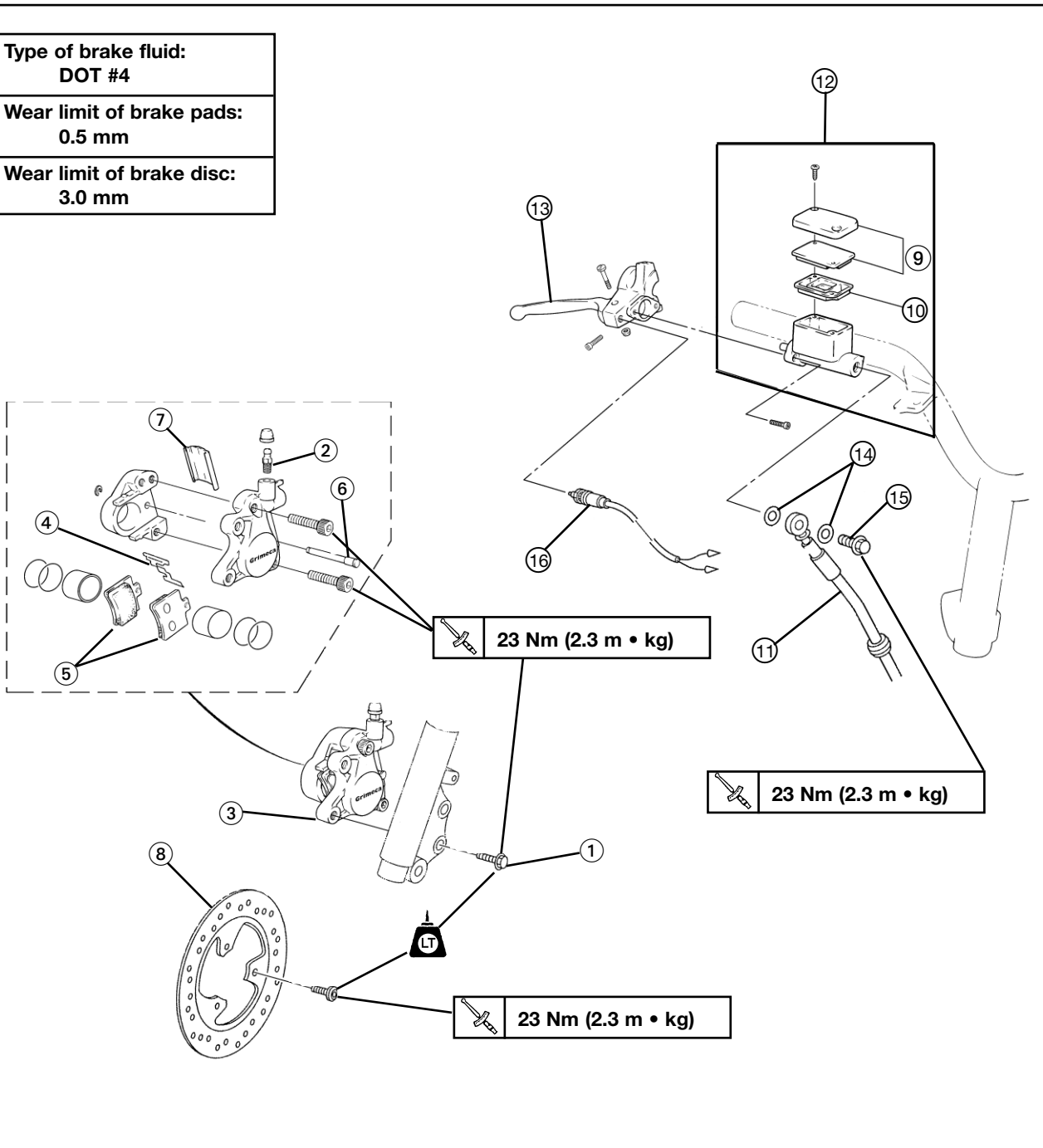

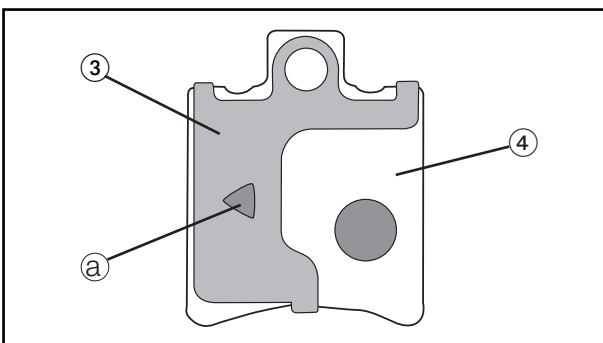
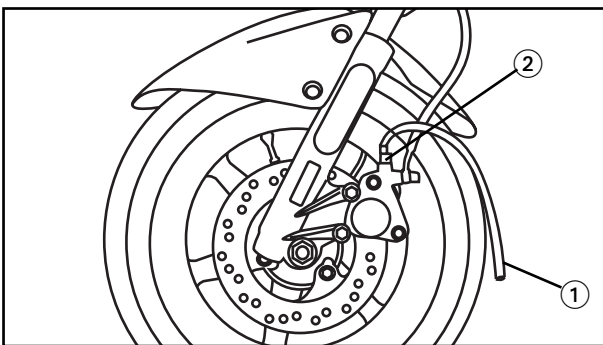
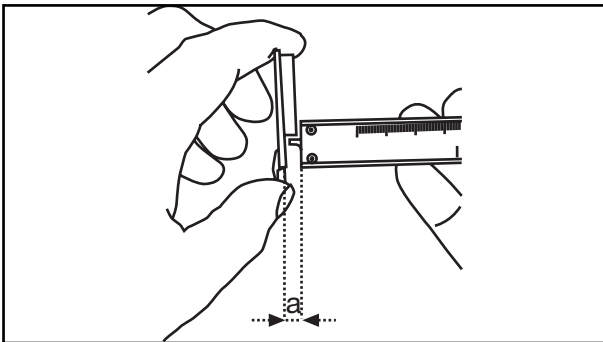
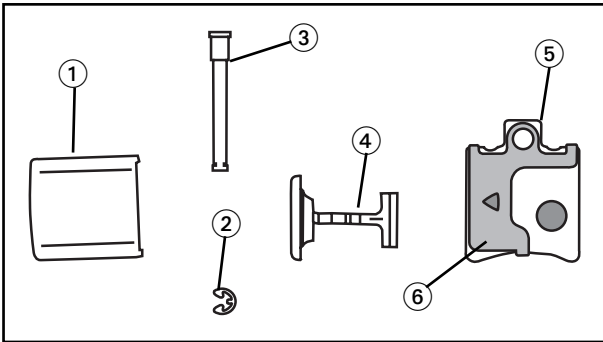
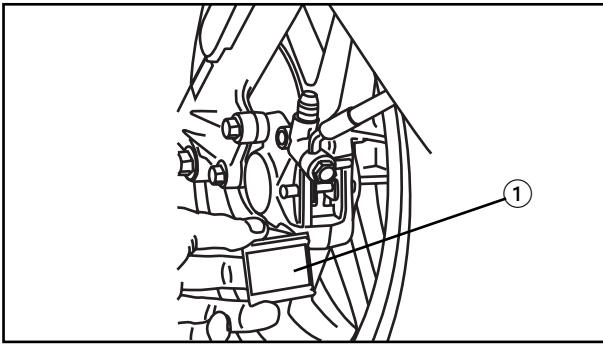

EAS00583

## REPLACING THE FRONT BRAKE PADS

### NOTE:

When replacing the brake pads, it is not necessary to disconnect the brake hose or disassemble the brake caliper.

#### 1. Remove:

- brake pad cover ①
- brake pad clip ②
- brake pad pin ③
- brake pad spring ④

#### 2. Remove:

- brake pads ⑤  
(along with the brake pad shims ⑥)

#### 3. Measure:

- brake pad wear limit @  
Out of specification → Replace the brake pads as a set.



**Brake pad wear limit**  
**0.5 mm**

#### 4. Install:

- brake pad shims  
(onto the brake pads)
- brake pads
- brake pad spring

### NOTE:

Always install new brake pads, brake pad shims, and a brake pad spring as a set.



- Connect a clear plastic hose ① tightly to the bleed screw ②. Put the other end of the hose into an open container.
- Loosen the bleed screw and push the brake caliper pistons into the brake caliper with your finger.
- Tighten the bleed screw.



**Bleed screw**  
**6 Nm (0.6 m• kg)**

- Install a new brake pad shim ③ onto each new brake pad ④.