

Disassembly and Assembly

C6.6 Engines for Caterpillar Built Machines

Media Number -KENR6081-15

Publication Date -01/03/2014

Date Updated -04/03/2014

i02786701

Wastegate Solenoid - Remove and Install

SMCS - 1057-010

Removal Procedure

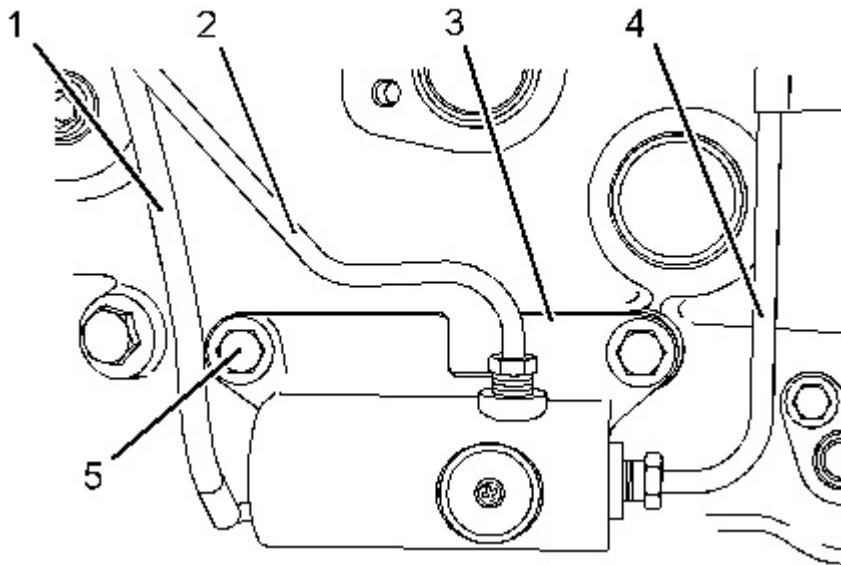

Illustration 1
Typical example

g01335778

1. Follow Steps 1.a through 1.c in order to disconnect wire lead (1).
 - a. Disconnect wire lead (1) from the harness assembly.
 - b. If harness assembly (1) is secured with a cable strap, remove the cable strap.
 - c. Remove wire lead (1) from tube assembly (2).

Note: The wire lead is secured to the tube assembly with clips.
2. Disconnect tube assembly (2) from wastegate solenoid (3).
3. Disconnect tube assembly (4) from wastegate solenoid (3). If tube assembly (4) is secured with tube clips, loosen the bolts for the tube clips.

Note: The tube clips must be loose in order to release the tube assembly from the wastegate solenoid.

4. Remove bolts (5) and remove wastegate solenoid (3) from the cylinder block.
5. Plug or cap all open ports and tube assemblies with new plugs or caps.

Installation Procedure

1. Remove the plugs or caps from all ports and tube assemblies.

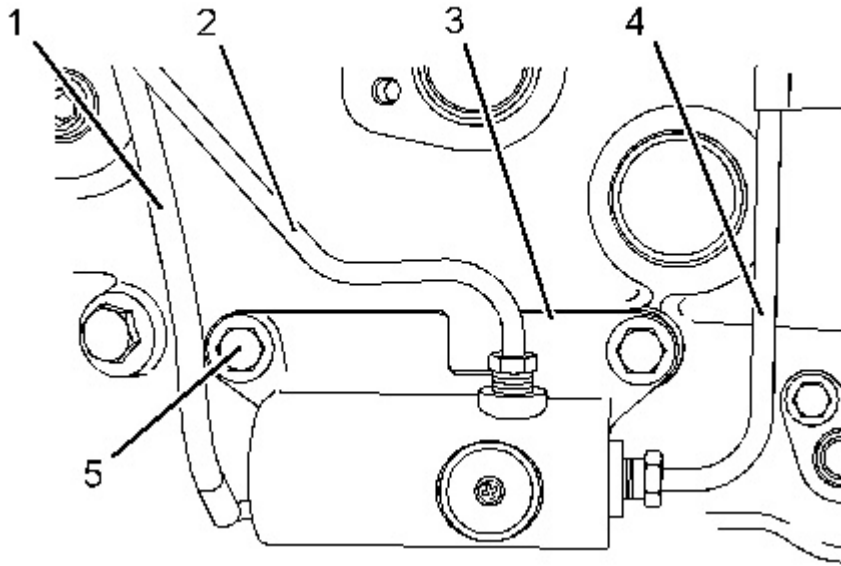

Illustration 2
Typical example

g01335778

2. Loosely install wastegate solenoid (3) to tube assembly (2).
3. Loosely install tube assembly (4) to wastegate solenoid (3).
4. Install bolts (5) to wastegate solenoid (3). Tighten bolts (5) to a torque of 44 N·m (32.5 lb ft).
5. Tighten tube assemblies (2) and (4) to a torque of 22 N·m (16 lb ft).
6. If tube assembly (4) is secured with tube clips, tighten the bolts for the tube clips.

Tighten M8 bolts to a torque of 22 N·m (16 lb ft). Tighten M10 bolts to a torque of 44 N·m (32.5 lb ft).

7. Follow Steps 7 through 7.c in order to connect wire lead (1).
 - a. Install wire lead (1) to tube assembly (2).
 - b. Connect wire lead (1) to the harness assembly for the engine.
 - c. If wire lead (1) is secured with a cable strap, install a new cable strap.
-

Disassembly and Assembly

C6.6 Engines for Caterpillar Built Machines

Media Number -KENR6081-15

Publication Date -01/03/2014

Date Updated -04/03/2014

i02786742

Water Pump - Install

SMCS - 1361-012

Installation Procedure

Table 1

Required Tools			
Tool	Part Number	Part Description	Qty
A	-	Guide Stud (M8 by 70 mm)	2

NOTICE

Keep all parts clean from contaminants.

Contaminants may cause rapid wear and shortened component life.

NOTICE

Care must be taken to ensure that fluids are contained during performance of inspection, maintenance, testing, adjusting and repair of the product. Be prepared to collect the fluid with suitable containers before opening any compartment or disassembling any component containing fluids.

Dispose of all fluids according to local regulations and mandates.

1. Ensure that the water pump is clean and free from wear or damage. If necessary, replace the water pump.
-

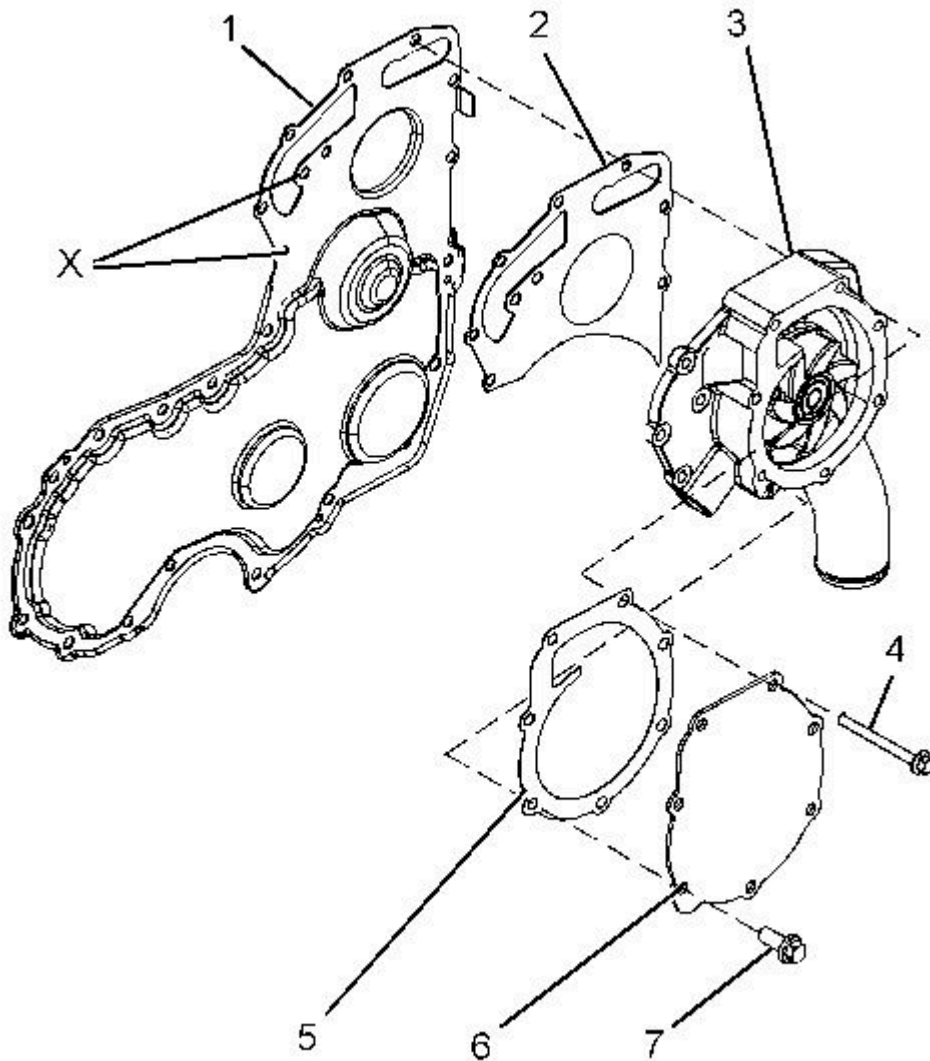

Illustration 1

g01336659

2. If necessary, install cover (6) to water pump (3). Follow Steps 2.a through 2.d in order to install the cover.
 - a. Clean the mating surface of cover (6).
 - b. Position a new joint (5) on water pump (3).
 - c. Install cover (6) to water pump (3).
 - d. Install bolts (7) to cover (6). Tighten bolts finger tight.
 3. Clean the mating surface of front cover (1).
-