

Disassembly and Assembly

C6.6 Generator Sets

Media Number -KENR9121-02

Publication Date -01/03/2014

Date Updated -04/03/2014

i02786955

Alternator - Install - Alternators with Mounting Lugs

SMCS - 1405-012

Installation Procedure

NOTICE

Keep all parts clean from contaminants.

Contaminants may cause rapid wear and shortened component life.

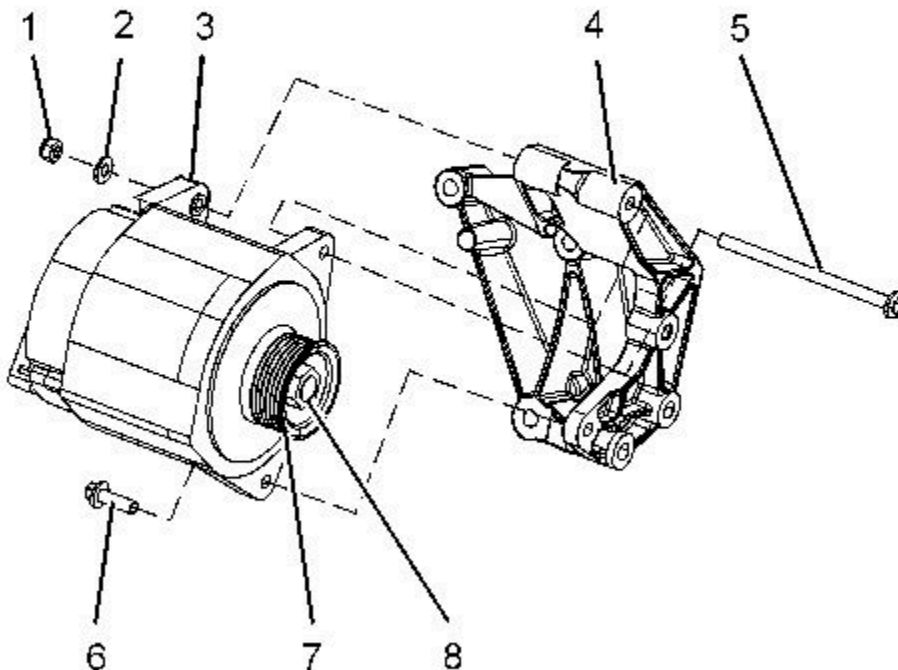

1. If necessary, install pulley (7) and nut (8) to alternator (3). Hold the shaft of alternator (3) with an allen wrench. Use a cranked ring spanner in order to tighten nut (8).

Note: Different types of alternator have different sizes of nut. Ensure that the correct torque value is used for the nut.

Tighten M16 and M17 nuts to a torque of 80 N·m (59 lb ft). Tighten 5/8 inch - 18 UNF nuts to a torque of 102 N·m (75 lb ft).

2. Position alternator (3) on alternator mounting bracket (4).
 3. Install bolt (5) to alternator (3). Install washer (2) and nut (1) to bolt (5).
 4. Install bolt (6) to alternator (3).
 5. Tighten nut (1) and bolt (6) to a torque of 22 N·m (16 lb ft).
 6. Connect wiring harness assembly to alternator (3).
 7. Install the alternator belt. Refer to Disassembly and Assembly, "Alternator Belt - Remove and Install".
 8. Turn the battery disconnect switch to the ON position.
-

Disassembly and Assembly

C6.6 Generator Sets

Media Number -KENR9121-02

Publication Date -01/03/2014

Date Updated -04/03/2014

i02786956

Electric Starting Motor - Remove and Install

SMCS - 1453-010

Removal Procedure



Accidental engine starting can cause injury or death to personnel working on the equipment.

To avoid accidental engine starting, disconnect the battery cable from the negative (-) battery terminal. Completely tape all metal surfaces of the disconnected battery cable end in order to prevent contact with other metal surfaces which could activate the engine electrical system.

Place a Do Not Operate tag at the Start/Stop switch location to inform personnel that the equipment is being worked on.

1. Turn the battery disconnect switch to the OFF position.
 2. Place identification marks on the harness assembly that is connected to the electric starting motor and the solenoid.
-