

Disassembly and Assembly

C3.3 Industrial Engine

Media Number -KENR6212-01

Publication Date -01/07/2006

Date Updated -02/05/2017

i02245824

Alternator - Install

SMCS - 1405-012

Installation Procedure

Note: If the alternator pulley was removed, install the alternator pulley and the nut (3). Tighten the nut to a torque of 80 N·m (59 lb ft).

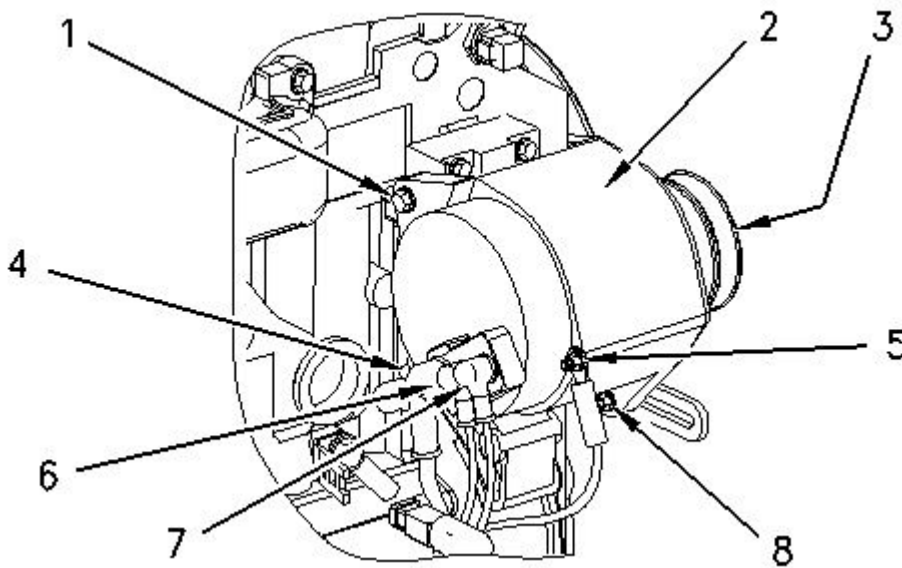

Illustration 1
Typical Example

g00999883

1. Put the alternator (2) in position onto the engine.
2. Install the nut and the setscrew (1). Tighten the nut finger tight.
3. Install the tension adjustment setscrew (8) through the adjustment bracket and into the alternator. Do not tighten the tension adjustment setscrew (8) at this time.
4. Install the V-belts onto the alternator pulley. Adjust the tension on the V-belts by moving the alternator (2) away from the engine. Tighten the tension adjustment setscrew (8) after the correct belt tension is made. Refer to the Specifications Manual, "Belt Tension Chart" for the correct tension of the V-belts.

5. Tighten the nut and the setscrew (1).
 6. Connect the harness assemblies (4), (6), and (7) to the alternator.
 7. Connect the ground harness assembly (5) to the alternator.
 8. Refer to the Specifications Manual, "Alternator " for the correct torque for the terminal nuts.
 9. Turn the battery disconnect switch to the ON position.
-

Disassembly and Assembly

C3.3 Industrial Engine

Media Number -KENR6212-01

Publication Date -01/07/2006

Date Updated -02/05/2017

i02463721

Electric Starting Motor - Remove and Install

SMCS - 1453-010

Removal Procedure

1. Ensure that the battery is disconnected or isolated.
2. Place an identification mark on all of the harness assemblies that are connected to the starting motor (4).

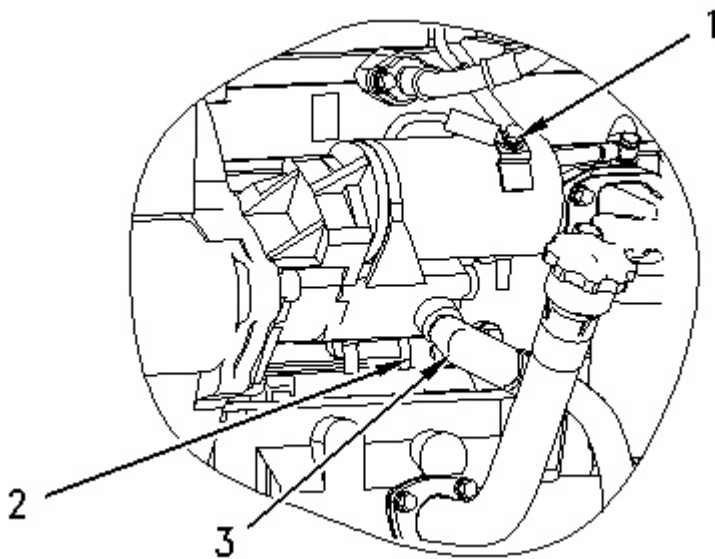

Illustration 1
Typical Example

g00999973

3. Disconnect the ground harness assembly (1) from the starting motor (4).
 4. Disconnect the harness assembly (2) and disconnect the harness assembly (3) from the starting motor (4).
-

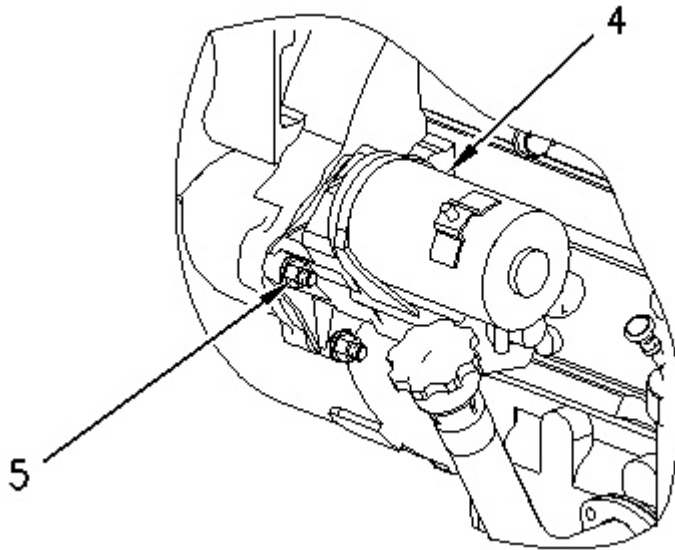

Illustration 2
Typical Example

g00999956

5. Remove the nuts (5) from the studs.
6. Remove the electric starting motor (4) from the flywheel housing.

Installation Procedure

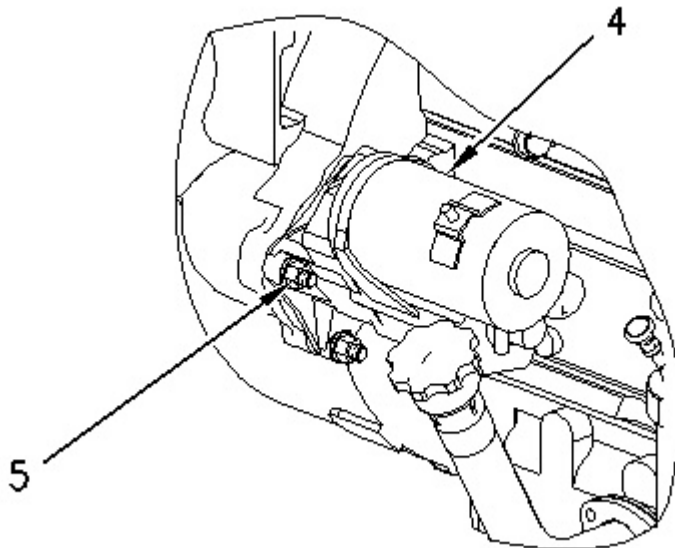

Illustration 3
Typical Example

g00999956

1. Install the electric starting motor (4) onto the flywheel housing.
2. Install the nuts (5) onto the studs. Tighten the nuts (5) to a torque of 44 N·m (32 lb ft).

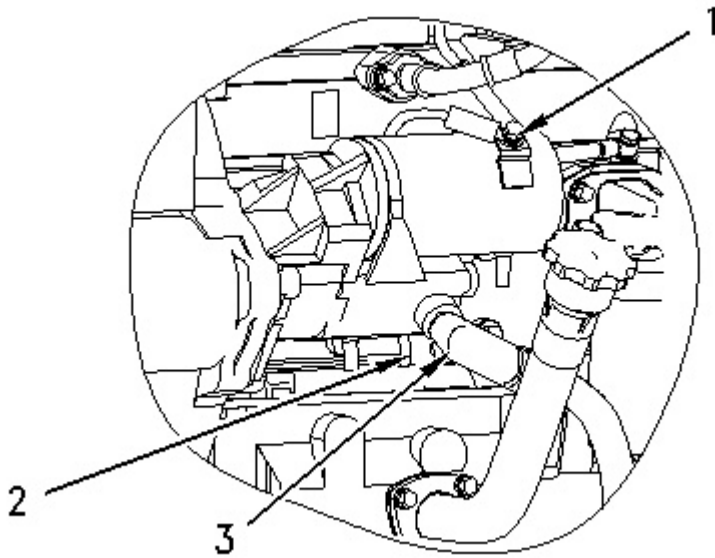

Illustration 4
Typical Example

g00999973

3. Connect the harness assembly (3), and the harness assembly (2) to the electric starting motor (4). Refer to the Specifications Manual, "Starter Motor" for the appropriate torques for the terminal nuts.
 4. Connect the harness assembly (1) to the electric starting motor (4). Refer to the Specifications Manual, "Starter Motor" for the appropriate torques for the terminal nuts.
 5. Turn the isolator for the battery to the ON position or reconnect the battery.
-