

Disassembly and Assembly 3064 and 3066 Engines for Caterpillar Built Machines

Media Number -SEN5553-10

Publication Date -01/05/2012

Date Updated -15/05/2012

i01147762

Turbocharger - Assemble

SMCS - 1052-016

Assembly Procedure

NOTICE

Keep all parts clean from contaminants.

Contaminants may cause rapid wear and shortened component life.

Note: During the assembly procedure, ensure that the index marks are aligned when the components are assembled.

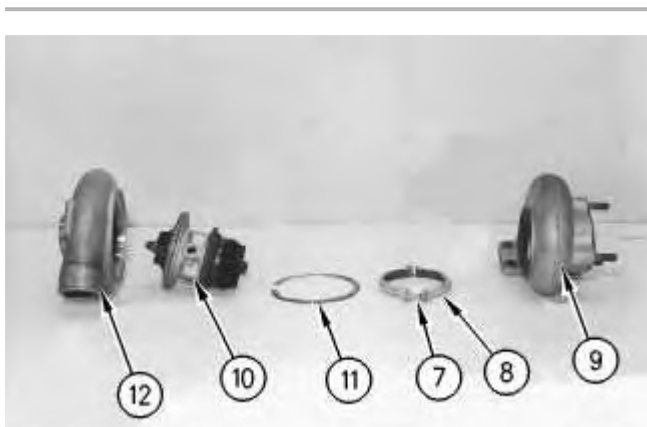

Illustration 1

g00608452

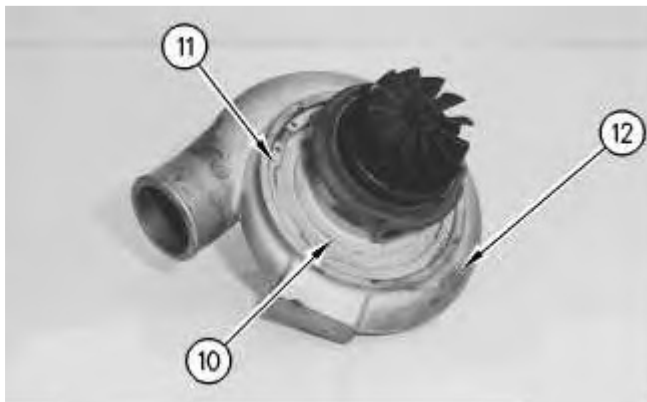

Illustration 2

g00608415

1. Install cartridge (10) into compressor housing (12) .
2. Install snap ring (11) into compressor housing (12) .

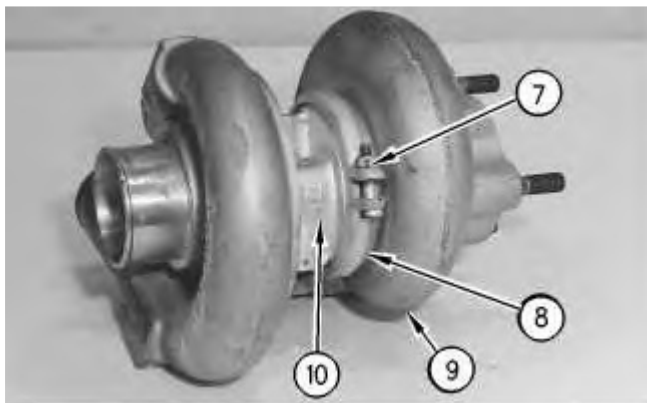

Illustration 3

g00608342

3. Install cartridge (10) into turbine housing (9) .
4. Install clamp (8) that secures cartridge (10) and turbine housing (9) together. Install the bolt and nut (7) into clamp (8).

Note: Refer to the Specifications Module, "Turbocharger" for information on the clamp.

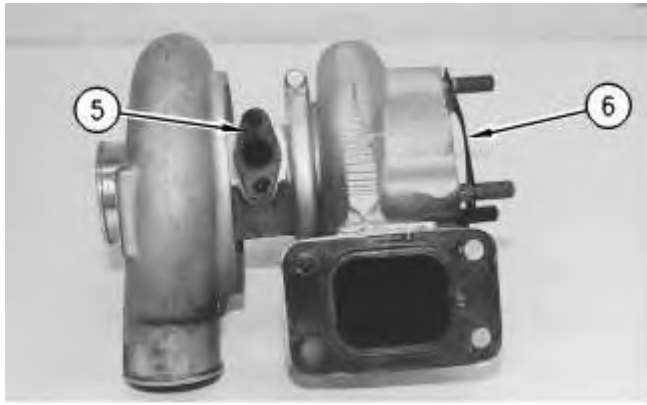

Illustration 4

g00608210

5. Inspect the condition of the gaskets. Replace the gaskets, if necessary.
6. Install gasket (6) on the turbine housing.
7. Install gasket (5) on the cartridge.

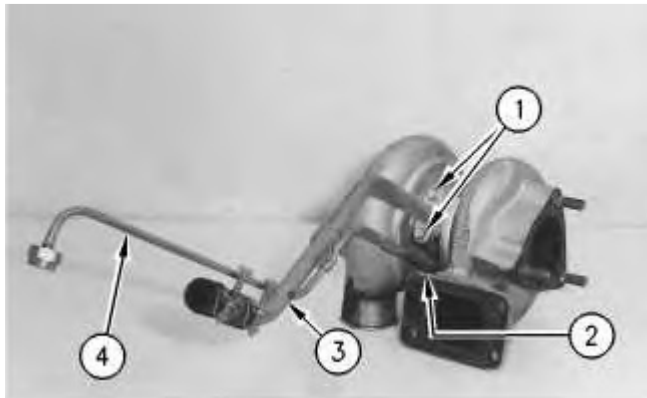

Illustration 5

g00608212

8. Place oil supply line (4) in position. Secure the oil supply line with bolt (2) (not shown).
9. Place oil return line (3) in position. Secure the oil return line with two bolts (1) .

End By: Install the turbocharger. Refer to Disassembly and Assembly, "Turbocharger - Install".

Thu Jul 20 15:35:48 PDT 2017